



# SC4500 MASTERSHADE®

## Exterior Rolling Zipper Screen / Large Cassette

The SC4500 is an exterior rolling zipper shade which can be used for sun and insect control or used with clear vinyl windows for light weather protection. The fabric runs inside vertical zippered guide tracks by means of gravity. A specially designed horizontal weighted hem bar keeps the fabric taut. The SC4500 box is 5 3/16" deep, and 5 1/4" high. The SC4500 shades are also ideal for use in conjunction with some Pergola® model awning systems as side screens to create an enclosure.

Type	Standard Frame Colors	Standard Widths	Standard Heights	Recommended Applications	Recommended Fabrics
Screen Exterior Retractable	9 standard Sunair colors	Through 20' wide Depending on height Fabric and Type	Through 16' high Depending on width, Fabric & Type	Residential and commercial restaurant porches and lenai	Various Mesh & Ferrari 502 vinyl fabric

- Larger standard box screen.
- Zipper retention system for fabric.
- Ideal with mesh fabric or vinyl fabric and windows.
- Optional "U" channels available for easy installation on uneven walls and columns.
- Gear or Motorized operation.
- Cassette bolts to ceiling or wall without brackets.

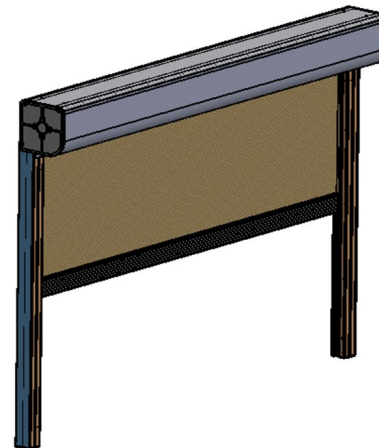

Revised 02/06/2019

# BENEFITS OF ZIPPER SCREENS WITH MESH



- Creates an instant screened in porch with the ability to revert to a full open porch when desired.
- Zipper fabric retention will keep pesky bugs at bay when using a closed mesh fabric.
- Reduces patio temperatures and keeps your space cooler.
- Cuts down on solar glare while retaining your view depending on mesh fabric type and openness factor.
- Cuts down on interior fading of floors, carpets and furniture.



# BENEFITS OF ZIPPER SCREENS WITH WINDOWS



- Great for residential and commercial spaces like restaurants.
- Creates an instant enclosed space by lowering the shades.
- Keeps moderate weather at bay by keeping rain and moderate winds from reaching the space.
- Adding heaters will heat the space and make it usable during cooler months.



# SC4500 Mastershade® Installations





**Hem bar:**  
**Front view 2" High**  
**3/4" Wide front to back**

**Track**

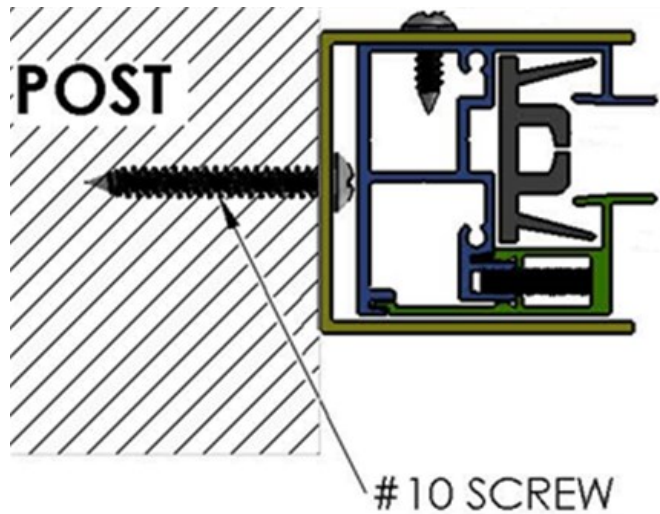

Track with optional "U" channel can be added if mounting between columns. The U channel is typically only used if either top opening or bottom opening between columns is more than the other.

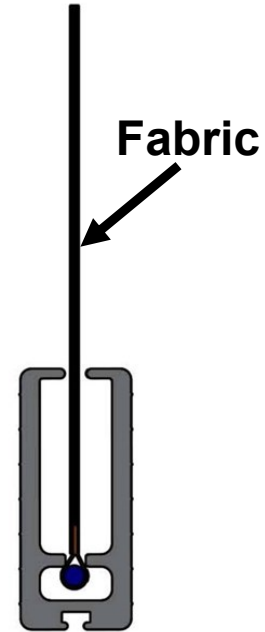

**Hem bar: Side view**

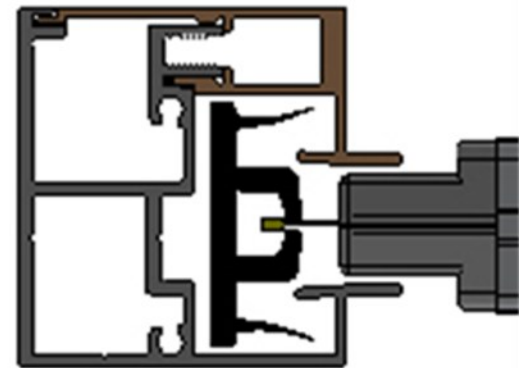

**Standard track with zipper and track assembly.**

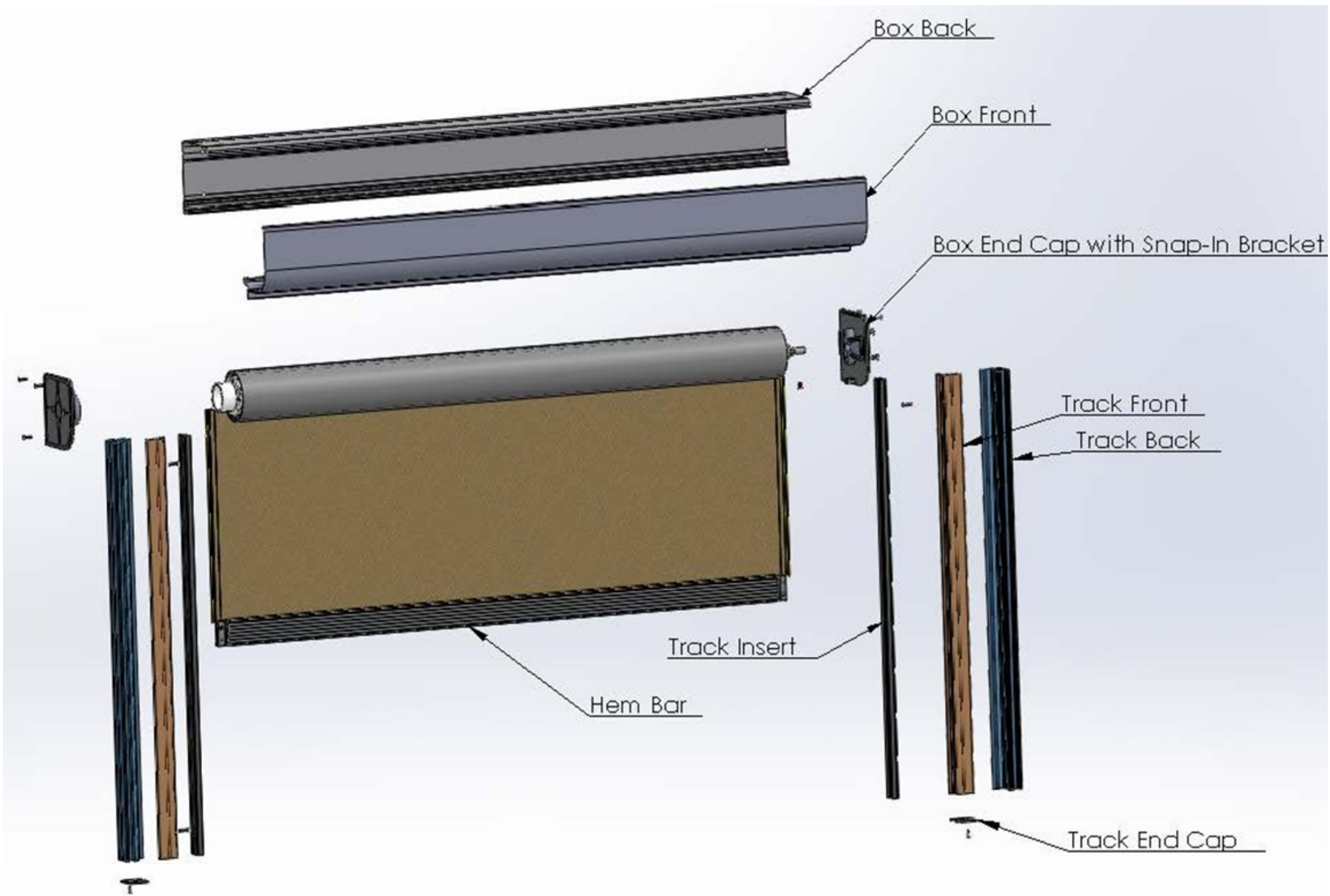

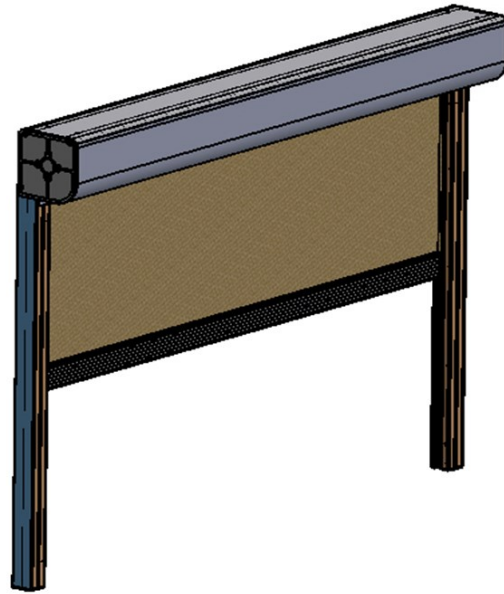
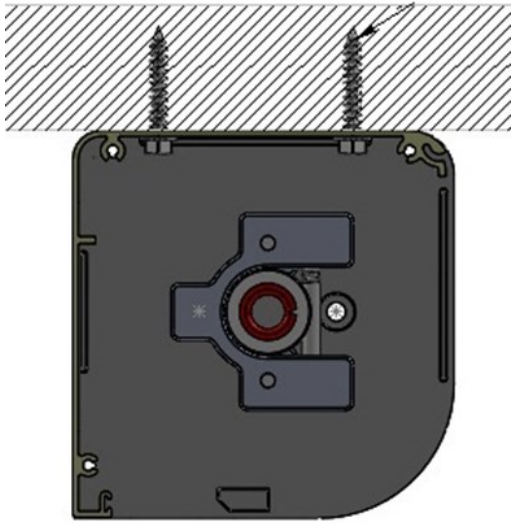

Ceiling or wall mounting cassette possible

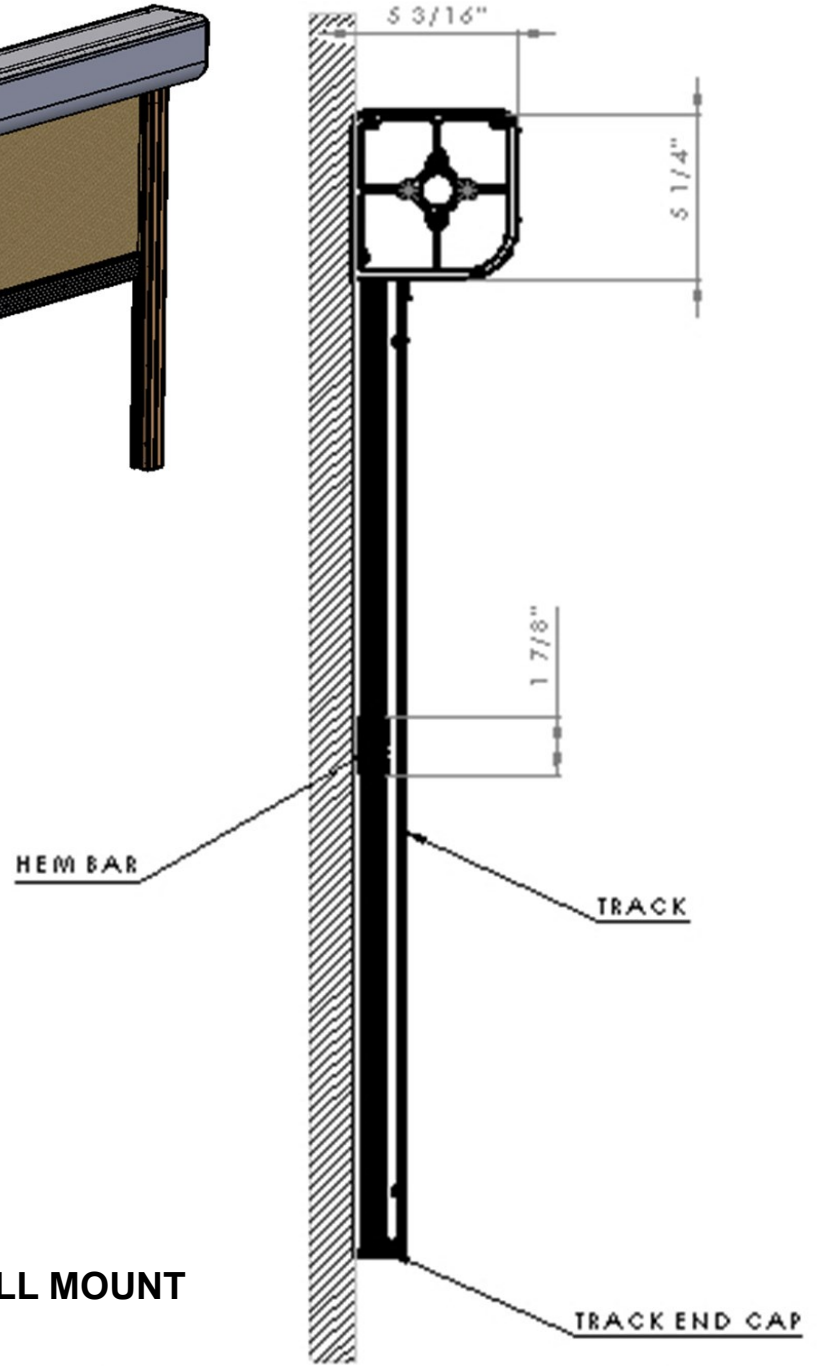
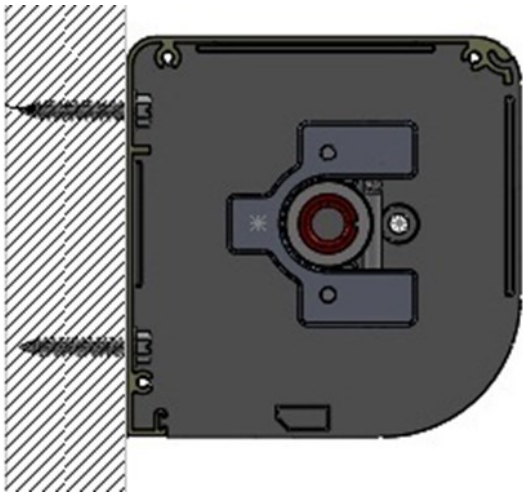

TYPICAL WALL MOUNT

# SC4500 SCREEN WITH ZIPPER

## SC4500 FEATURES:

## SUNAIR BENEFIT

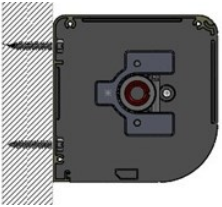
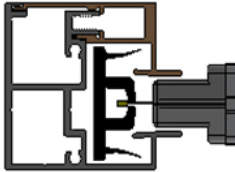
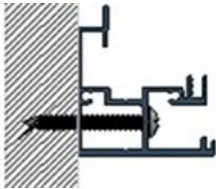
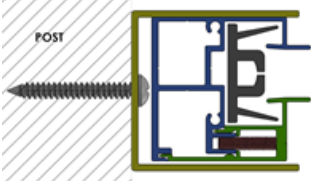
<p><b>Easy to install and remove roller tube</b></p>		<p>The SC4500 uses our heavy duty SC3569M metal idler bracket with a removable bushing.</p>	<p>The metal idler bracket makes it easy to remove the roller tube and fabric assembly for ease of installation of the cassette. It is designed to withstand the torque of larger heavy shades.</p>
<p><b>Install cassette without brackets</b></p>		<p>The SC4500 cassette installs right onto the <u>wall</u> or directly onto <u>ceiling</u> using smaller screws without the need for brackets.</p>	<p>Eliminating brackets makes for faster installation and a cleaner look.</p>
<p><b>Internal PVC zipper insert with winglets</b></p>		<p>The SC4500 “Zipper” insert PVC has soft “winglets” on each side of the zipper channel.</p>	<p>Vinyl winglets on the insert PVC provide tension while offering flexibility to expand and contract for the fabric as the temperature changes.</p>
<p><b>Easily installation of track to wall or side</b></p>		<p>The SC4500 track is easily attached to the back wall or side wall using small screws rather than track brackets (Back wall shown).</p>	<p>Eliminating track brackets makes for a faster installation and a cleaner look.</p>
<p><b>U channel for un-even wall installation</b></p>		<p>The “U” channel can be added to the standard track.</p>	<p>This “U” channel makes it easier to install the tracks between uneven columns or inserting into columns for new construction.</p>



## **MEASURING SC4500:**

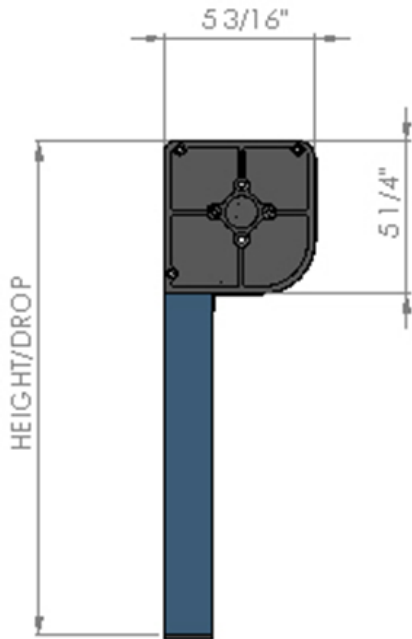

**Width:** Determine the desired width. The width of the screen is the measurement outside of track to outside of track and outside of cassette to outside of cassette end caps, as both are flush with each other. The track is  $1 \frac{13}{16}$ " wide on each side (See Figure 1). The cassette mounts without using any brackets right on the wall or ceiling. If you mount the tracks on wood trim that protrudes out from the wall, the back of the cassette will have to be built out as well so that it becomes flush with the back of the tracks. The tracks also install right on the wall or post surface with screws (See sketch on next page).

**CEILING MOUNTING BETWEEN PILLARS:** If mounting under a patio or ceiling mounting the height is not adjustable and height is total height of opening. If mounting between pillars use the narrowest dimension and deduct  $\frac{1}{8}$ " to  $\frac{1}{4}$ ". If there is a very little difference on the width from top to bottom, you may be able to choose the narrowest and install the tracks right to the column and caulk. If distance is bigger, you should add U channels. If ordering the "U" Channels Sunair, will reduce the width of the fabric and hem bar by  $\frac{3}{4}$ " to allow for the installation of the U channels with about  $\frac{3}{8}$ " play on each side (see drawing next page). Sunair will not reduce the width of the cassette, only the width of fabric, zipper tracks, and hem bar.

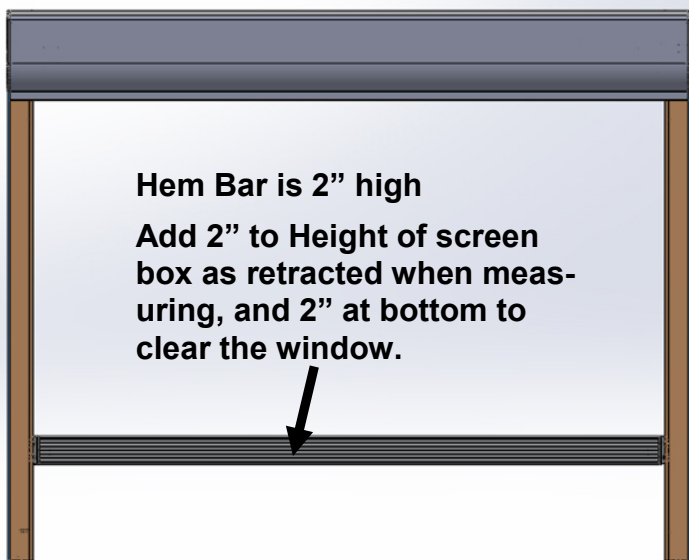

**WALL SURFACE MOUNTING:** If mounting in front of a window opening, add at least 4" to the width of the opening or glass area to fit the screen. If surface mounting determine the height of the opening or window.

### **HEIGHT:**

The fabric or screen mesh should cover the height of the window. The height of the screen includes the cassette height. To calculate the height of the shade if surface mounting to front wall consider adding the height of the cassette ( $5 \frac{1}{4}$ ") plus 4" (2" at top and 2" at bottom) to the total height of opening to be covered (see sketches on left). This way, the hem bar is not seen while shade is retracted or extended. Also watch out for casement windows that will interfere with the hem bar when the shade is retracted (In such a case, mount the top of the cassette  $7 \frac{1}{2}$ " - 8" above the opening window edge). In addition, add 2" at the bottom, so the lowered hem bar goes past the glass edge for a total of about 10" to the height.

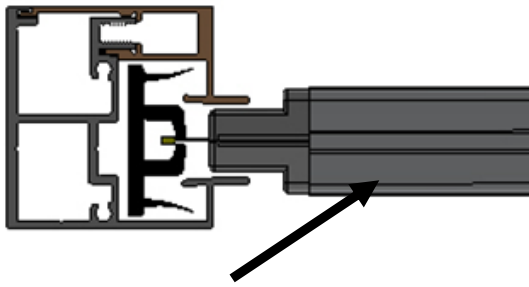

Hem bar: Top view  
 $\frac{3}{4}$ " wide front to back

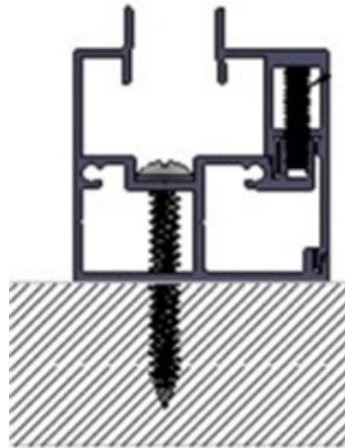

SIDE MOUNTED TRACK

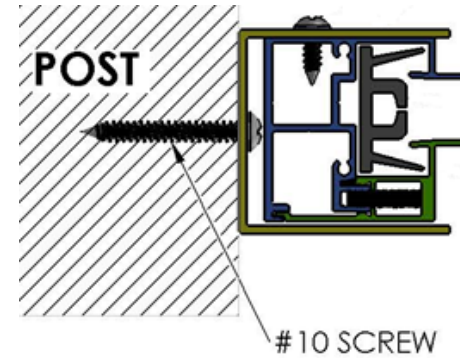

SIDE MOUNTED TRACK WITH U CHANNEL

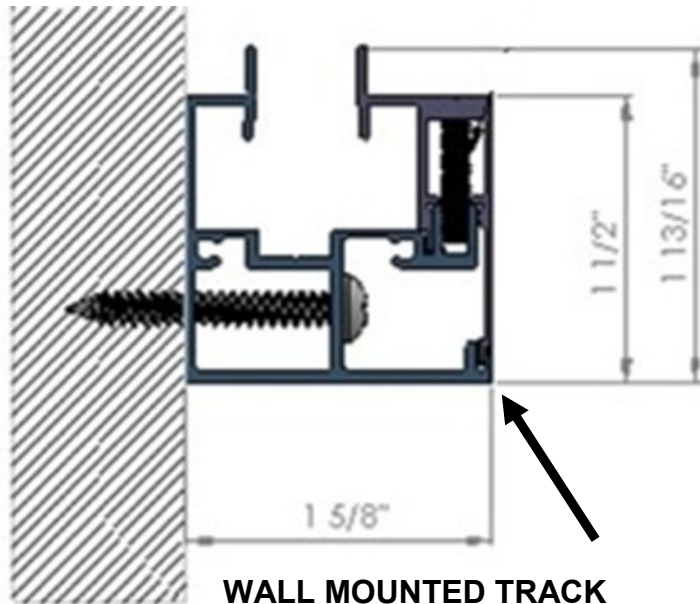

WALL MOUNTED TRACK

If using the "U" Channels, Sunair will reduce the width of the fabric and hem bar (Not cassette) to allow for the installation of the U channels between pillars with about  $\frac{3}{4}$ " - 1" (Allowing for  $\frac{3}{8}$ " to  $\frac{1}{2}$ " play on each side). This takes into consideration the screw and wall thickness of the actual U channel so screen can be installed. Unless deductions were made in production, U channels cannot be added later.

# FRAME COLORS ( STANDARD )

## *Awnings & Screens\**

\*Note: See each model technical page for available frame colors.

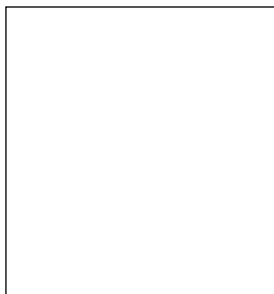

**WHITE Gloss**  
Ral 9016

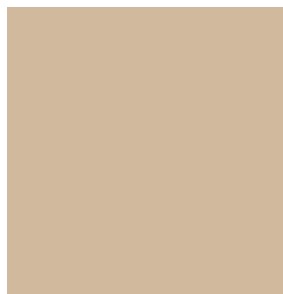

**MOCHA**  
Semi Gloss

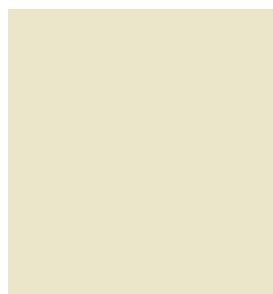

**DESERT SAND /  
IVORY Gloss**



**BLACK Gloss**  
Ral 9005



**BRONZE**  
Coarse



**GREY Gloss**  
Ral 7040

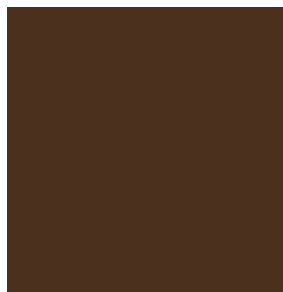

**BROWN Gloss**  
Ral 8019

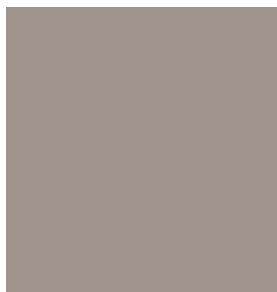

**TAUPE Gloss**  
Ral 7030

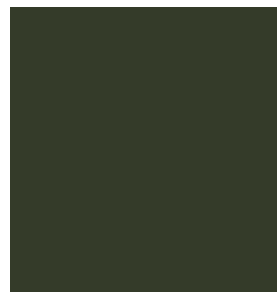

**GREEN Gloss**  
Ral 6005

### OPTIONAL

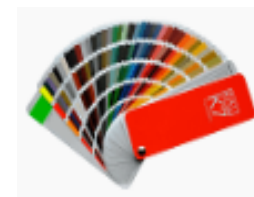

**FULL RAL COLOR  
RANGE / EXTRA COST**

**NOTE: ACTUAL FRAME COLOR MAY VARY FROM DIGITAL IMAGES**



RecScreen  
5000P

Exterior Screen Fabric



300 Charcoal / Charcoal

## Specifications

---

**Composition:** 15% Polyester, 85% Vinyl

**Syle:** Basket Weave

**Mesh Weight:** 14,75 (oz/yd<sup>2</sup>)

**Openness Factor:** 5.5 %

**Fabric Thickness (in):** .026

**Width:** 118"

**Fire classification:** NFPA 701 Test 1, and CA Fire Marshall Title 19, Section 1237.1

**Warranty:** 5 years exterior

**Bacteria and Fungal Resistance:** AATCC Test Method 100-2004



001 White  
/ Linen

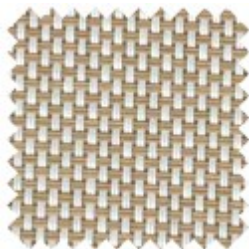

002 Blanco  
/ Sable

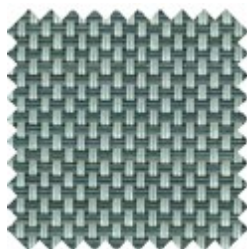

405 Pearl  
/ Dark Grey



305 Charcoal  
/ Dark Grey



307 Charcoal  
/ Bronze

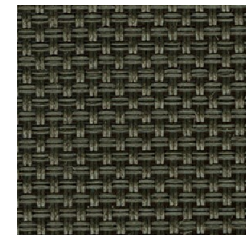

770 Bronze  
/ Bronze

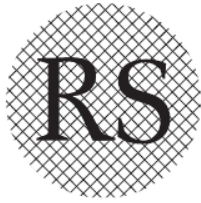

# RecScreen

6000P

Exterior Screen Fabric



300 Charcoal / Charcoal

## Specifications

**Composition:** 18% Polyester, 82% Vinyl

**Style:** Twill

**Mesh Weight:** 17,8 (oz/yd<sup>2</sup>)

**Openness Factor:** 3 %

**Fabric Thickness (in):** .78 mm

**Width:** 118"

**Fire classification:** NFPA 701 Test 1, and CA Fire Marshall Title 19, Section 1237.1

**Warranty:** 10 Year Limited. Visit [www.recasensusa.com](http://www.recasensusa.com) for full warranty.

**Bacteria and Fungal Resistance:** AATCC Test Method 100-2004



001 White  
/ Linen



002 White  
/ Sable

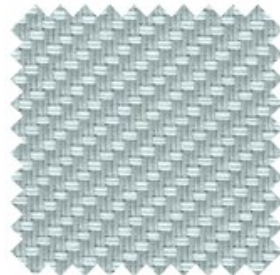

004 White  
/ Pearl Grey

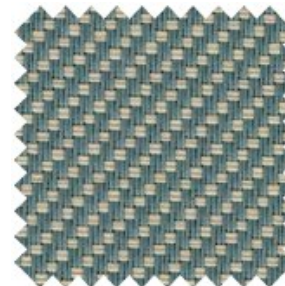

502 Dark  
Gray / Sable

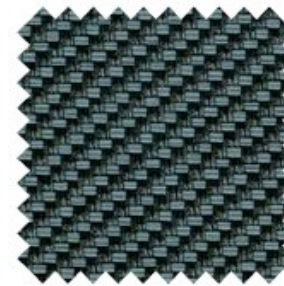

503 Dark  
Gray / Charcoal



307 Charcoal  
/ Bronze

# PHIFER **TuffScreen**®

**Standard Heavy-Duty Insect Screening**

Exterior Screen Fabric  
Zipper Screens only



## Specifications



**Standard Color:** Black

**Standard Widths:** 36" (91.4cm), 48" (121.9cm), 60" (152.4cm), 72" (182.9cm), 84" (213.4cm), 96" (243.8cm), 108" (274.3cm) and 120" (304.8cm)

**Standard Roll Lengths:** 100' (30.48m) in all widths and 50' (15.24m) in all widths except 120"

**Packaging:** Individually wrapped in protective paper

- Heavy-duty, vinyl-coated polyester insect screening
- Ideal for use in high-traffic areas
- Durable – resists damage from pets, tears and punctures
- Excellent choice for patios, porch enclosures, retractable systems, windows and doors

**Soltis**  
Horizon 86

**Serge Ferrari**

14 % Open Screen Mesh

Exterior Screen Fabric

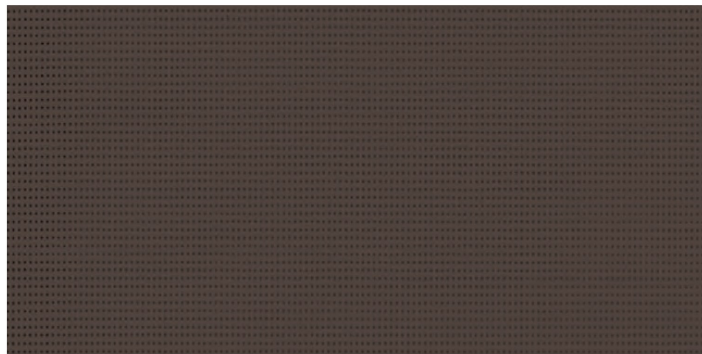

86-2043  
Bronze

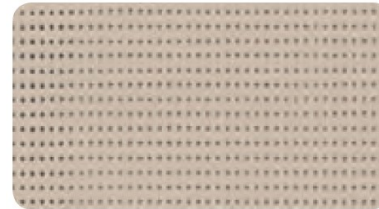

86 – 2135  
Sandy Beige

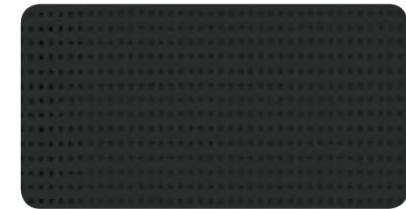

86 – 2053  
Black

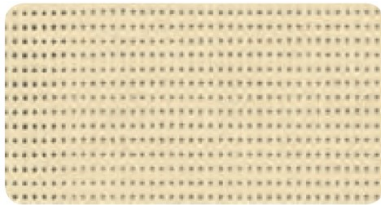

86 – 2175  
Champagne

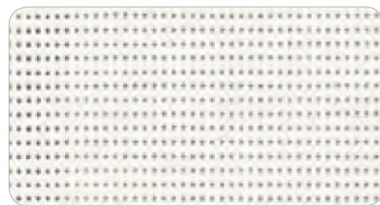

86 – 2044  
White

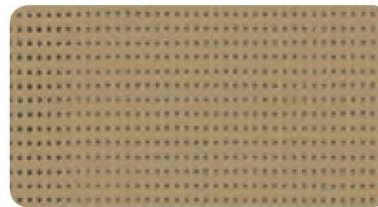

86 – 2012  
Pepper



86 – 2171  
Boulder

■ **Technical properties**

Openess factor	14%
Weight	380 g/m <sup>2</sup> — 11.2 oz/sqyd
Thickness	0.45 mm — 450 microns
Width	177 cm - 267 cm — 69.7 in. - 105.1 in.

Superior elongation and tear resistance

No deformation during processing and use

Superior aesthetic and mechanical durability

Smooth finish easy to clean, space saving, easy rolling

# Exterior Screen Fabric



5 % Open Screen Mesh

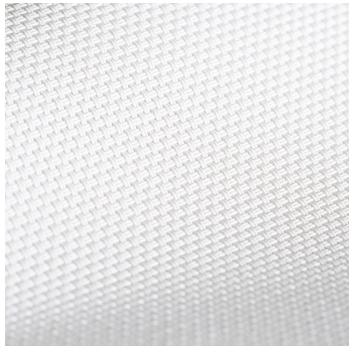

White



Stone Texture

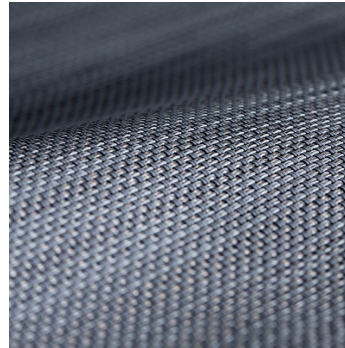

ShadowTexture



Granite

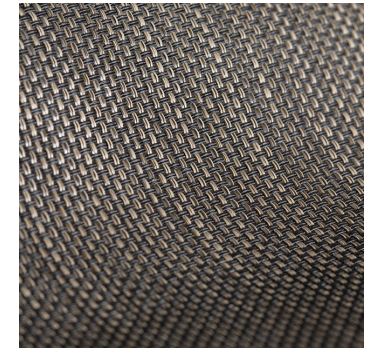

Espresso Texture

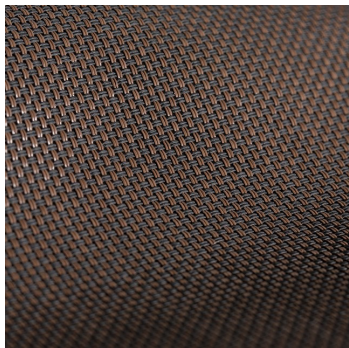

Tobacco

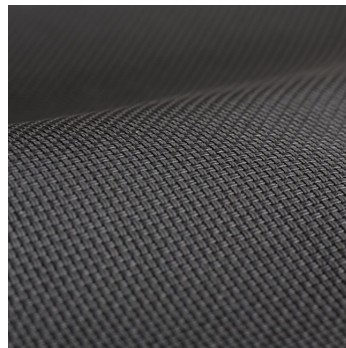

Charcoal

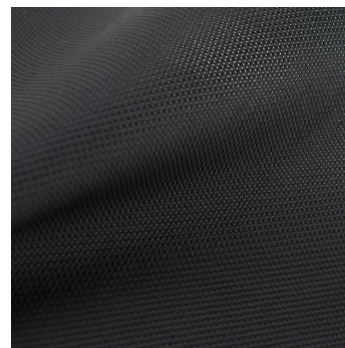

Flat Black



Bone

TEXTILENE® nano™ 95 is a durable, yet lightweight synthetic fabric. It is lighter and finer with the same technical qualities as the original TEXTILENE®. TEXTILENE® nano™95 is excellent for exterior use and can reduce energy costs while blocking up to 95% of the sun's harmful rays.





## 502 PROOF SOLTIS / OPAQUE SATINE FINISH COLORS

The Preconstraint 502 fabric from Ferrari also offers excellent dimensional stability with minimal stretching and exceptional dirt resistance thanks to a PVDF topcoat on both sides. The fabric is therefore perfect for use on retractable zipper screens with window film. The fabric is 16.8 oz / sq. yd. with a satin finish. Fabrics are fire retardant / certificate is available upon request.



satin finish

# MOTORIZATION & AUTOMATION



Awnings



Exterior Screens



Pergolas



Roller/Solar Shades

Sunair is proud to offer the full line of Somfy motors and controls for our screen program. SOMFY RTS features motors with an integrated radio receiver that allows you to operate the awning by remote control with a wall mounted or hand held remote or by smart phone device. With a simple click of a button on your remote, the shade will extend or retract automatically.



ALTUS®



## AVAILABLE BATTERY OPERATED REMOTES



Telis 1 & 4 RTS  
Hand-held Remotes



Telis 16 RTS  
Hand-held Remote

One (1) through (16) channel hand held or wall mounted remotes are available. Remotes are available in different colors to suit your style, please inquire.

Telis hand-held remotes offer convenient and simple operation of every type of motorized application. Channels help organize the motorized products that are operated. Single channel remotes can operate one individual product or one group of motorized products. Multiple channel remotes can handle groups of motorized products.



Telis 1 Chronis  
RTS Timer



DecoFlex WireFree™ RTS  
Wall Switches



Telis 1 Patio for  
exterior use



Smooove® 1 RTS  
Surface Mount Wall Switch

# AVAILABLE SENSORS & CONTROLS



**SOLIRIS RTS 24V KIT**

**Sun & Wind Sensor**

The Soliris RTS Sun and Wind Sensor automatically controls your RTS motorized products based on current weather conditions.



**ONDEIS® WIREFREE**

**Sun & Rain Sensor**

The Rain Sensor is a solar-powered combined rain and sun sensor compatible with Radio Technology Somfy® motorized exterior products, including awnings and screens.

The Somfy myLink™ is a simple device that turns your smartphone or tablet into a sophisticated remote control for motorized products featuring Radio Technology Somfy®, allowing you to operate them whether you're home or not. Combine all the benefits of Somfy's RTS hand-held remotes and timers in a convenient app.



**Sunis & ThermoSunis  
Indoor WireFree™ RTS Sensors**

# SOMFY MOTOR WIRING



## Radio Technology Somfy

Radio Technology Somfy® (RTS) allows wireless radio control of motorized applications via the RTS family of controls.

## All Somfy Motors are UL and CSA Recognized

- All SOMFY motors are UL Recognized and can be found under the following file numbers:

E60495, E60888, E63714



The three (3) wire cords can be wired in parallel and can be ordered with a molded plug to simply plug into an exterior UL approved GFI outlet. The standard four (4) wire cords must be wired with a traditional toggle wall switch. Screens can not be ordered with molded plugs on the end.

## Type of power cable

RTS plug in capable motor cord

RTS  
120V AC / 60Hz  
3 conductor cable

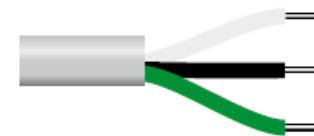

white = neutral  
black = hot  
green = ground

## Type of power cable

Hardwire motor cord

Wired  
120V AC / 60Hz  
4 conductor cable



white = neutral  
red = direction 1  
black = direction 2  
green = ground

## Hardwired motors with a wall switch

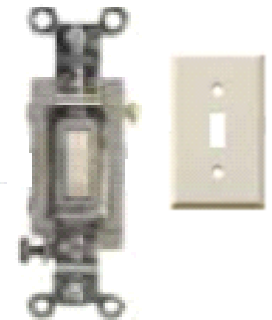
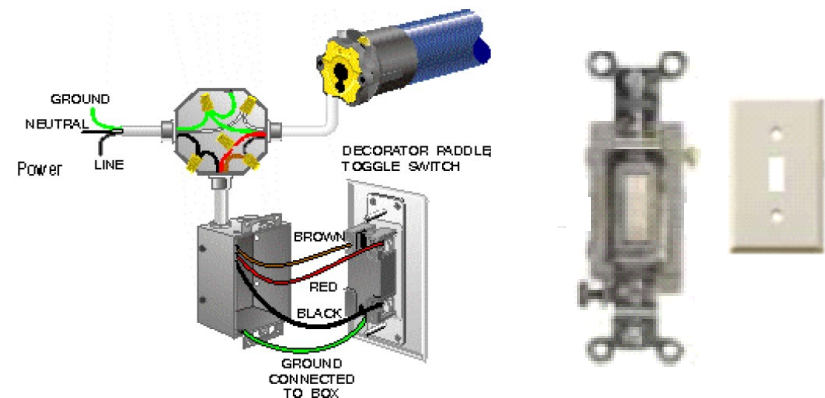

## Dimensions

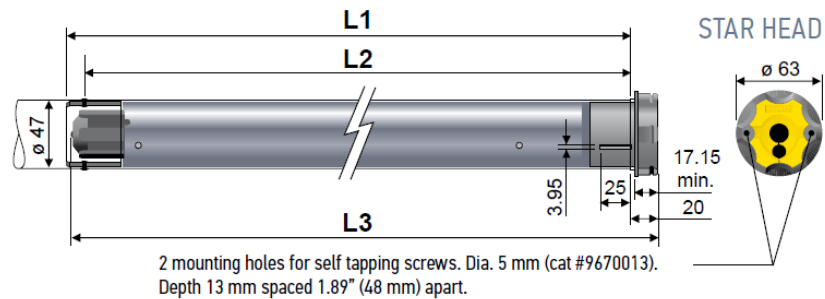

# LT50 Altus® RTS

506	510	525	535	550
6 Nm	10 Nm	25 Nm	35 Nm	50 Nm
120V / 60HZ	120V / 60HZ	120V / 60HZ	120V / 60HZ	120V / 60HZ
1.1A	1.3A	1.6A	2.1A	2.1A
38 rpm	38 rpm	20 rpm	20 rpm	14 rpm

## ***MAESTRIA OSTACLE***

### ***DETECTION EXTERIOR SCREEN MOTOR***



**The SOMFY Maestria obstacle detection motor is the recommended motor to be used for all zipper screens. These motors accurately detects obstacles, stopping after meeting an object traveling up or down. Protects carrier products and prevents fabric damage resulting from screen bunching and slipping from the guides. The motor senses and distinguishes between an actual obstacle and wind, even wind gusts, so it doesn't stop unnecessarily, resulting in fewer service calls and end user peace of mind.**

# Notes



# Notes

Note: Sunair® reserves the right to change engineering, specifications, and prices without notice.  
Images and Illustrations in the catalog may vary from digital and printed manuals.

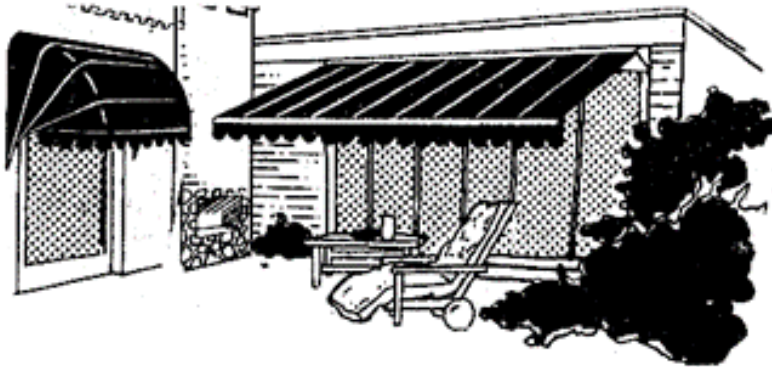

***SUNPROOFING AMERICA!***



**MARYLAND LOCATION**

Mailing: P.O. Box 1068

Shipping: 7785 Rt. 175

Jessup, MD 20794

Toll Free 800 - 548 - 0408

Phone: 410 - 799 - 1145

Fax: 410 - 799 - 5584

**ARIZONA LOCATION**

Mailing: Same as Jessup

Shipping: 3807 West Thomas Rd.

Phoenix, AZ 85017

Toll Free 877 - 272 - 3920

Phone: 602 - 272 - 3920

Fax: 602 - 272 - 3925

[www.sunairawnings.com](http://www.sunairawnings.com)

[info@sunairawnings.com](mailto:info@sunairawnings.com)