

SUNEA RTS CMO VISUAL REFERENCE GUIDE

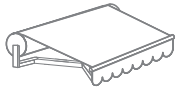

Setting for Standard Awning : Manual Up and Down Limits

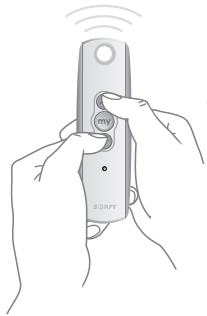

STEP 1

Initiate programming by pressing both the (Up) and (Down) buttons at the same time until the motor jogs.



STEP 2

Check the direction of operation. Press and hold the button and confirm it moves the motor out (the motor will be in momentary fashion). To change the direction press and hold the (Stop) button until the motor jogs.

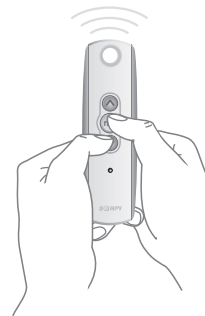

STEP 3

Bring the motor to your desired upper limit. Press and hold both the and buttons until the motor begins to move down, then release. Stop the motor where the lower limit should be set, you can adjust by pressing the or buttons.

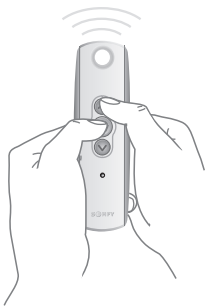

STEP 4

Press and hold the and buttons until the motor begins to move up. The motor will stop at the original upper point. Adjust if necessary.



STEP 5

Press and hold the button until the motor jogs to confirm the limit setting.



STEP 6

Press and hold the Program button on the back of the transmitter until the motor jogs. It will now operate in a maintained fashion. Double check limits as a precaution.

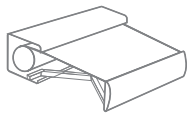

Setting for Cassette Awning: Automatic Up Limit

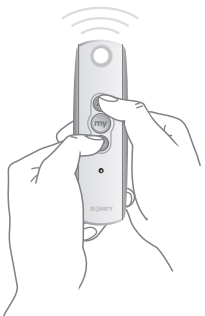

STEP 1

Initiate programming by pressing both the (Up) and (Down) buttons at the same time until the motor jogs.



STEP 2

Check the direction of operation. Press and hold the button and confirm it moves the motor out (the motor will be in momentary fashion). To change the direction press and hold the (Stop) button until the motor jogs.

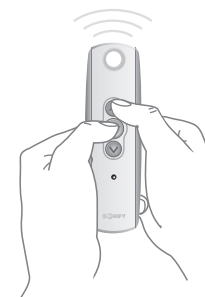

STEP 3

Bring the motor to your desired down limit. Press and hold both the and buttons until the motor begins to move up, then release.

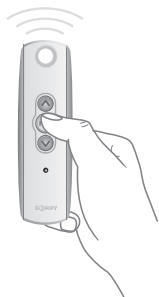

STEP 4

Press the button and stop the awning halfway



STEP 5

Press and hold the button until the motor jogs to confirm the limit settings. The motor will then automatically set its inner limit.



STEP 6

Press and hold the Program button on the back of the transmitter until the motor jogs. It will now operate in a maintained fashion. Double check limits as a precaution.

Please contact SOMFY for detailed installation instructions

ADJUSTING THE LIMITS

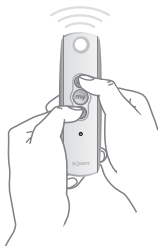

To change the lower limit:

Move the motor to its current lower limit position and let it stop. Press the ▲ and ▼ buttons simultaneously until the motor jogs, then release. Adjust to a new lower limit position. Press the MY button until the motor jogs, then release. Check new limit.

To change the upper limit:

Move the motor to its current upper limit position and let it stop. Press the ▲ and ▼ buttons simultaneously until the motor jogs, then release. Adjust to a new upper limit position. Press the MY button until the motor jogs, then release. Check new limit.

To add a remote/channel or sun and wind sensor:

First press the programming button on the back of the already programmed remote until the motor jogs. Then press the programming button on the remote or sun/wind sensor that you would like to add until the motor jogs. Check it.

To reset the motor:

you will need to disconnect power (120vac) for 2 seconds, reconnect for 10 seconds, disconnect for another 2 seconds and reconnect. The motor should start to move and then stop on its own (If this does not happen, continue to perform the disconnects until it does). Once the motor stops moving on its own, press and hold the programming button on the back of the remote and count to ten without letting go. The motor should jog twice.



ADVANCED FEATURES/FUNCTIONS

BACK IMPULSE function for both cassette and standard awnings

This function allows you to apply tension on the fabric when the awning is fully extended. The motor can be adjusted up to a ½ half turn.

To activate this function:

STEP 1

Set the awning to the lowest position.



STEP 2

Press the MY and Up buttons until the awning jogs: The motor is in programming mode.



STEP 3

Adjust the fabric's tension using the Up or Down buttons.



STEP 4

Press the MY button until the awning jogs: The fabric's tension has been programmed.



BACK RELEASE function on cassette awnings only

This function allows the fabric tension to be released after the cassette awning is closed.

To activate this function:

STEP 1

Cut the power, unless you are using the awning in the first 4 cycles.

STEP 2

Set the awning to the inner limit position.



STEP 3

Press the MY and Down buttons until the motor moves up and down: If the Back release function was deactivated, it is activated. If the Back release function was active, it is deactivated.



CLOSING FORCE function on cassette awnings only

This function enables the closing force of the cassette awning to be increased or decreased to 3 levels (high/medium/low). The motor is factory set at the medium level.

To activate this function:

STEP 1

Cut the power, unless you are using the awning in the first 4 cycles.

STEP 2

Bring the awning to the halfway position.

STEP 3

Briefly press the MY and Up buttons simultaneously, then immediately press and hold the MY and Up buttons until the motor jogs. The motor is only in programming mode for approx. 10 seconds.

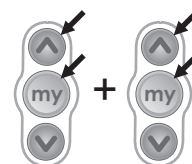

STEP 4

Adjust the closing force setting using the Up and Down buttons.
 - to increase the closing force, press the Up button until the motor jogs up and down.
 - to decrease the closing force, press the Down button until the motor jogs up and down.



Increases closing force



Decreases closing force

STEP 5

Press the MY button until the awning jogs up and down: The new closing force has been programmed.

