

## PRODUCT FEATURES:



- ☐ Mounts between walls, or underneath an existing steel or wood trellis structure.
- ☐ Protects against sun, rain,
- ☐ Keeps deck and patio cool
- ☐ Cover small to larger patio areas
- ☐ Great for restaurant dining areas and large residential patios
- ☐ Heavy duty all aluminum frame
- ☐ Manually operated up to 268 sq. ft. size as a Type 1.
- ☐ Motorization required on larger sizes
- ☐ Motorized with safety box
- ☐ Optional hood system recommended
- ☐ Integrated gutter optional

Pergola® TECNIC ONE is the stronger heavier version in the Tecnic line, and is utilized on special applications either mounted between walls or under wood trellis structures. This model offers the convenience of a retractable awning, yet the comfort and durability of a stationary awning. Now you can utilize your patio area during fierce mid-day sun and rain. This Pergola® system is great for restaurant and residential patio areas. Larger widths can be covered by coupling multiple frame beams together, while the fabric remains in one piece.

| <b>MODEL: TECNIC ONE</b>  | <b>Standard Frame Colors</b>  | <b>Standard Widths</b>   | <b>Standard Projections</b>                                 | <b>Recommend Application</b>          | <b>Fabric</b>  | <b>Options</b>                    |
|---|---|--|---|---------------------------------------|--|-----------------------------------|
|  | Anthracite<br>Grey Std.<br>White 9016<br>Cream 1013<br>Corten<br>& Sunair std. colors<br><br>Custom colors also available | Max 16 ft. with two beams and total 42' 7" wide with 3 sections And 4 guides | Up to 29' 6" projection<br><br>Between walls max projection | Restaurants, Large Residential Patios | Ferrari Precontraint 602<br><br>Optional: Ferrari 502 & 302 , Soltis 86 & 92 | Roll Screens<br>Heaters<br>Lights |

### 1. General

The Pergola® Tecnic **ONE** terrace awning is designed for restaurants, cafes and large residential terraces. The one system is permanent sun-shading frame system with a retractable fabric. The Tecnic One opens and closes by means of a manual gear or tubular motor. Multiple beams can be added together for wider widths with fabric in one piece. Maximum size available with 4 beams is 42' 6" wide x 29' 6' projection.

### 2. The fabric

Precontraint 602 is a waterproof fabric PVC fire-resistant Class 2, heat-sealed to provide higher water-proof quality.

### 3. Motor

The Pergola® Tecnic One is operated by a Somfy ALTUS radio 110v tubular motor with a control box. Either an LT50 or LT60 motor is used depending on the size of the unit. Somfy electronic controls are available as an option.

**4. Manual** The manual version is available in "single span" Type 1 versions up to 268 sq. ft. size or 25 sq. meters. The gear is a fast 4.4:1 gear for efficiency.

## Pergola® Model: TECNIC ONE

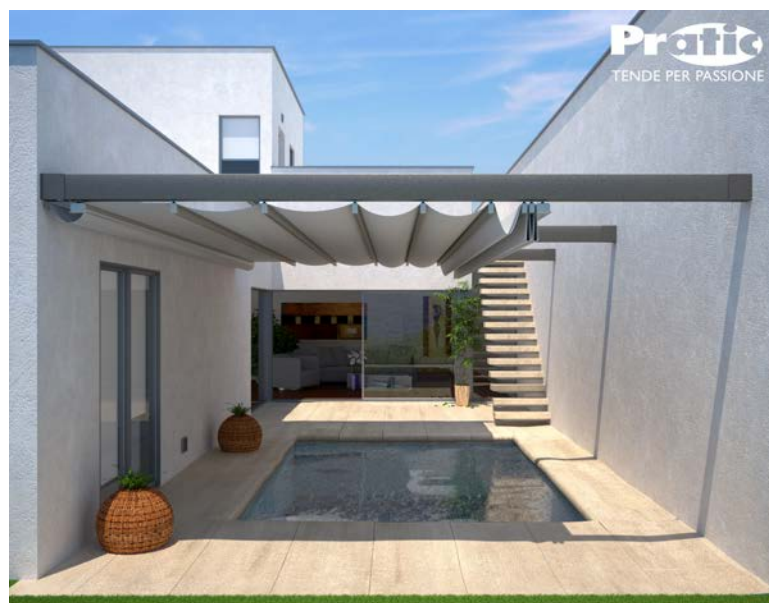

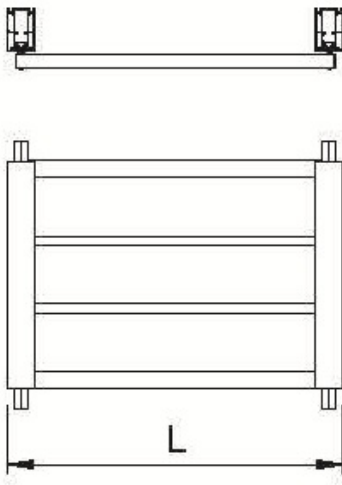

### **TYPE 1: ONE system**

**L = from 8' 1" to max 16' 5" wide**

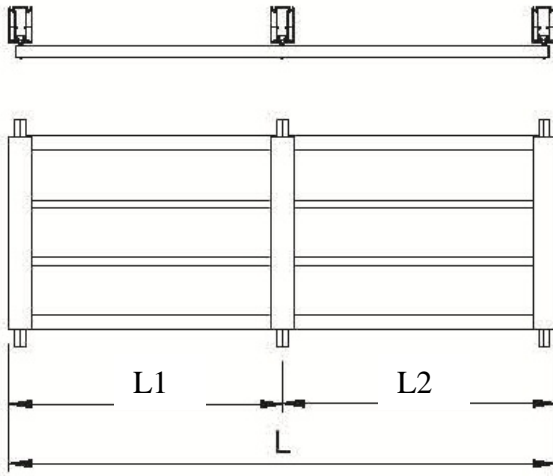

### **TYPE 2: ONE system**

**2 spans (L from 16' 4" to 29' 6" max total  
L1 & L2 from 8' 1" to 14' 8" wide**

### **TYPE 3: ONE system**

**3 spans (L from 27' 10" to 42' 6")  
L1, L2, & L3 from 9' 10" to 14' 1" wide**

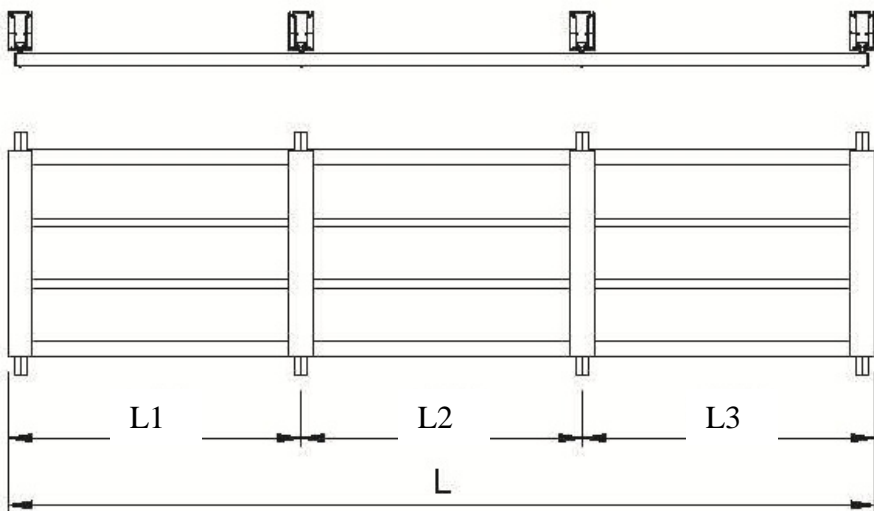

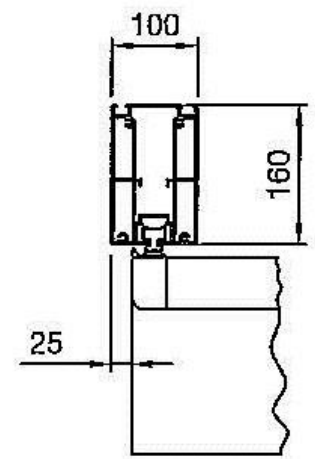
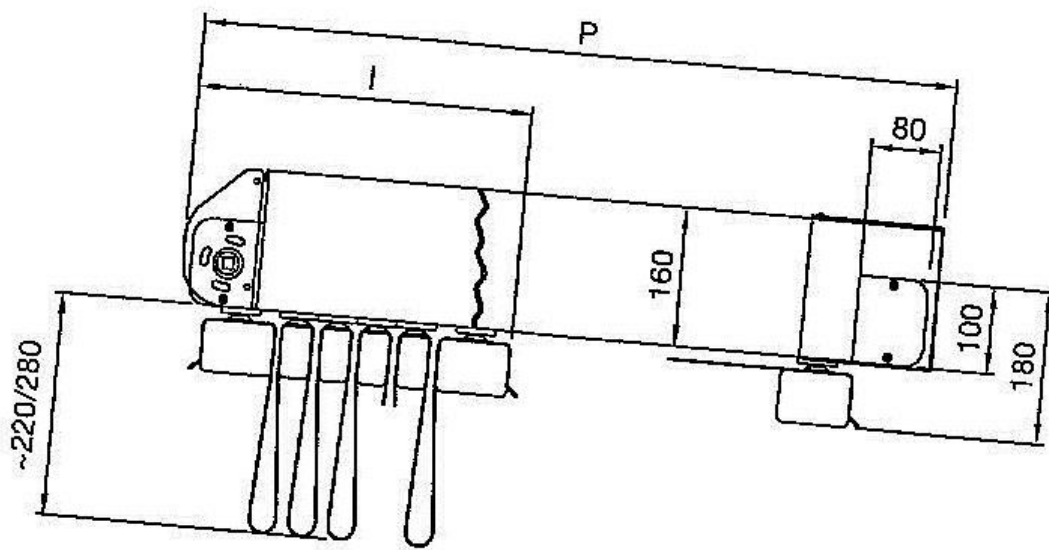

**FRONT  
SECTION**

### Dimensions:

- I =** Dimension when awning is retracted
- A =** Awning pitch
- M =** Actual Projection from wall
- P =** Actual Slope

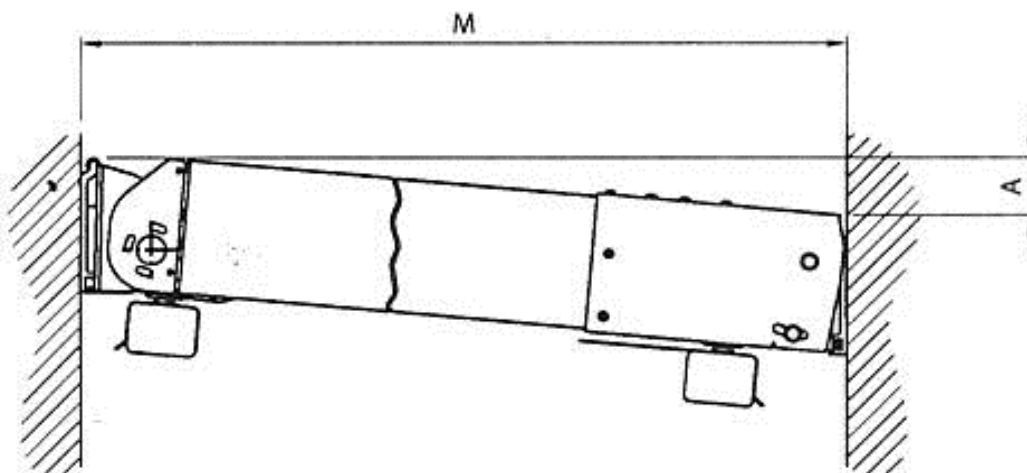
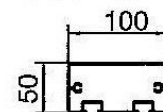
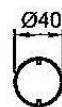
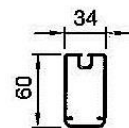
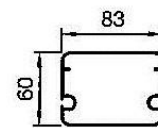
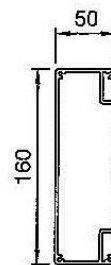
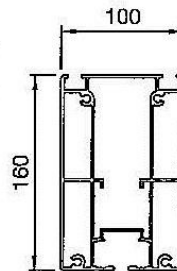
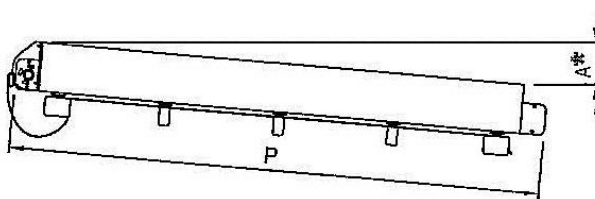

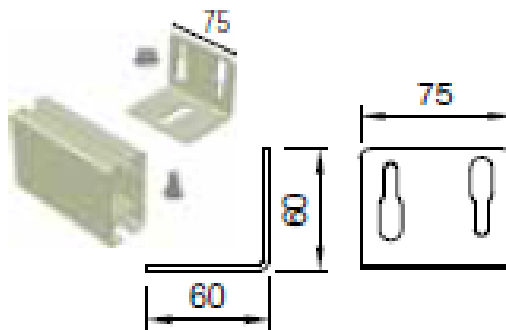
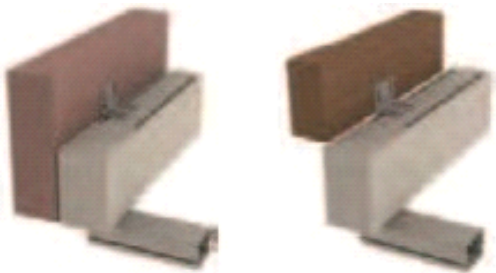

If mounting the guide profiles to a wood trellis or steel beam, special “L” brackets are spaced out evenly about every 6 ft. on each guide profile.

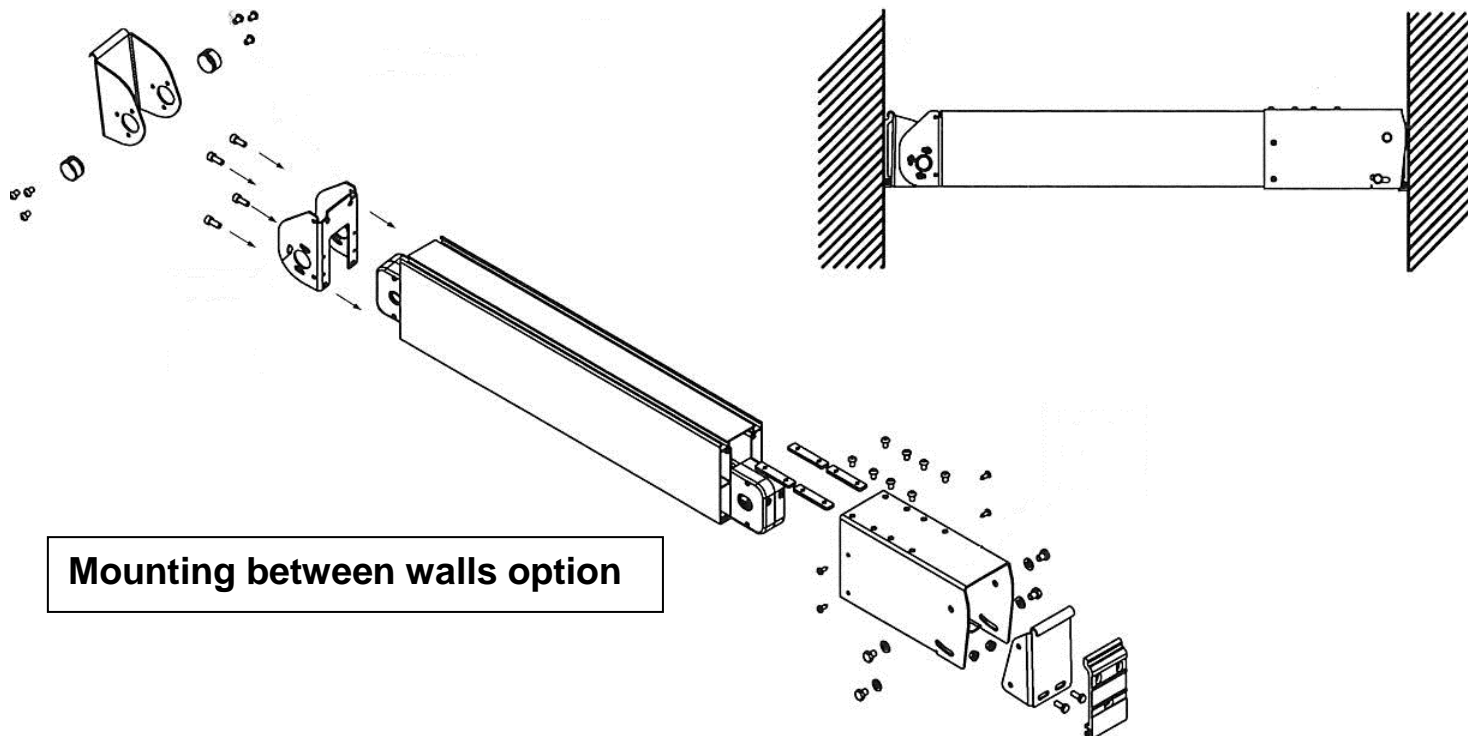

Mounting between walls option

available up to the full projection of 29' 6" between walls (see above). Finished projection is actual slope measurement.

If mounting to a wood structure or steel structure using “L” brackets, one L bracket is needed every 6 ft. approximately (see previous page).

### Note:

This product requires training at the Sunair facility in Jessup, MD. Sunair has staff available to help supervise the installation for an additional cost.

Further information please call our Jessup office.

©2017 AWNINGS UNLIMITED INC.  
P.O. Box 1068 7785 Rt. 175,  
Jessup, MD 20794

**JESSUP, MD      800 – 548 – 0408**

