

## **PRODUCT FEATURES:**



- ☐ Free standing Pergola® type
- ☐ Protects against sun, rain,
- ☐ Keeps deck and patio cool
- ☐ Covers small to larger patio areas
- ☐ Great for large residential patios and restaurant dining areas
- ☐ All aluminum frame
- ☐ Motorization required on all sizes
- ☐ Motorized with safety box
- ☐ Optional hood system
- ☐ Water drainage to the sides with “V” cover

Pergola® PHOENIX is a self-supporting free standing solution offering the convenience of a retractable awning, yet the comfort and durability of a stationary framework. Now you can utilize your patio area during fierce mid-day sun and rain. The water will drain to the sides using a V cut in the fabric to channel the water. This Pergola® system is great for residential patio areas.

<b>MODEL: PHOENIX</b>	<b>Standard Frame Colors</b>	<b>Standard Widths</b>	<b>Standard Projections</b>	<b>Recommend Application</b>	<b>Fabric</b>	<b>Options</b>
	<b>Anthracite Grey Std.</b>  <b>Optional:</b> White 9010 Cream 1013 & Custom colors also available	Up to 16' 5" with four (4) posts and up to 22' 11" with six (6) posts	Up to 19' 8" with four (4) posts and up to 32' 9" with six (6) posts	Restaurants, Large Residential Patios	Ferrari Preconstraint 602  Optional: Ferrari 502 & 302, Soltis 86 & 92	Hood Additional Arches

### **1. General**

The Pergola® **PHOENIX** terrace awning is designed for restaurants, cafes, and large residential terraces. The Phoenix system is free standing permanent sun-shading frame system with a retractable fabric. The Phoenix opens and closes by means of a tubular Altus motor. Either four (4) or six (6) posts are utilized depending on size needed.

Maximum size available with 6 posts is 22' 11" wide x 32' 9" projection.

### **2. The fabric**

Preconstraint 602 is a waterproof fabric PVC fire-resistant Class 2, heat-sealed to provide higher water-proof quality.

### **3. Motor**

The Pergola® Phoenix is operated by a Somfy ALTUS radio 110v tubular motor with a control box. Either an LT50 or LT60 motor is used depending on the size of the unit. Somfy electronic controls are available as an option.

### **4. Manual** A Manual version is not available.

# Pergola® Model: PHOENIX

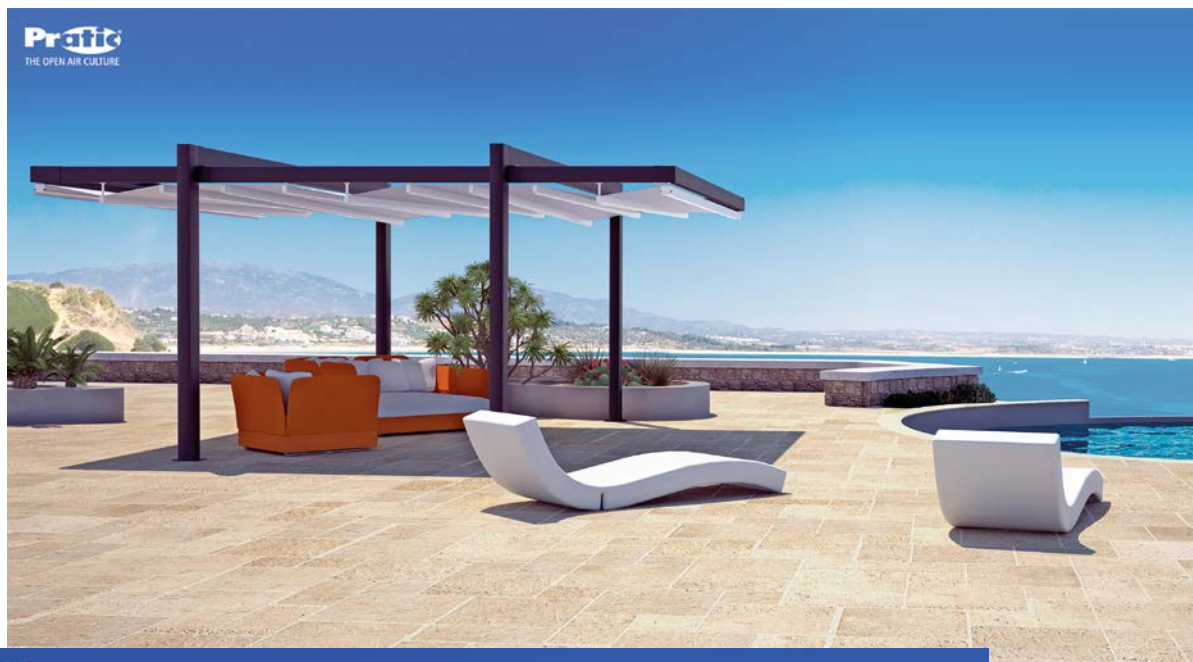

## **TYPE 2: Phoenix system with 4 posts / 1 span fabric**

**L = width = from 6' 7" to 22' 11" wide**

**P = projection = from 6' 6" to 19' 8" projection**

Front view

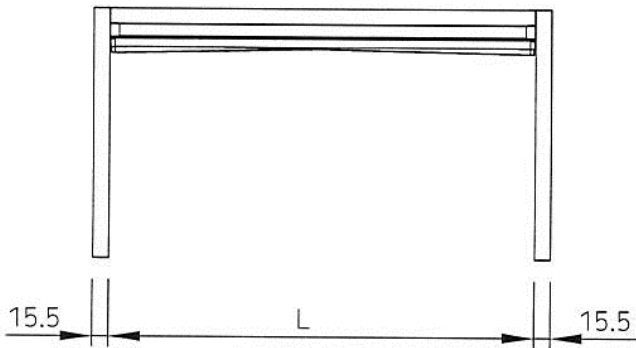

Side view

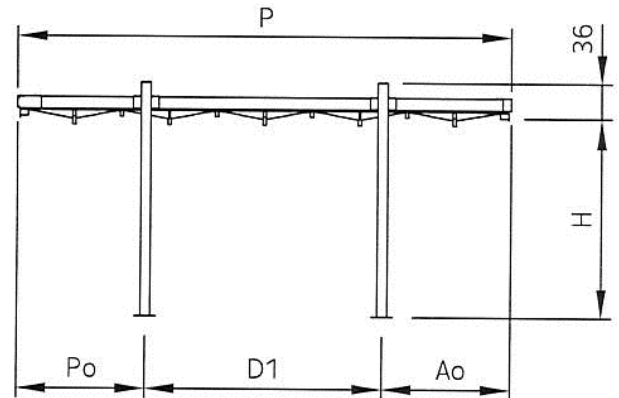

Po/Ao min 40cm - max 120 cm  
D1 > Po + Ao

View from above

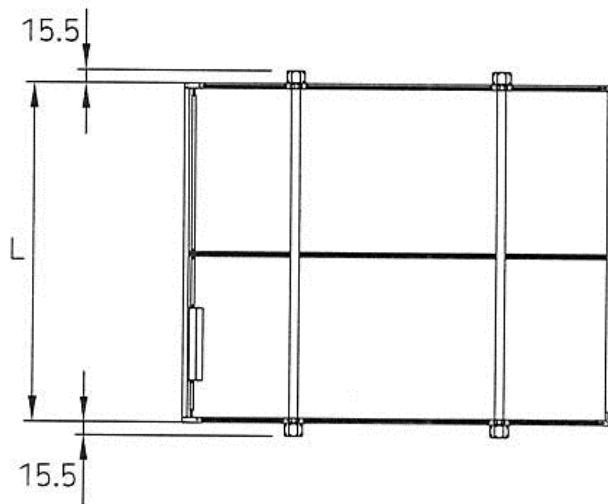

### **TYPE 3: Phoenix system with 6 posts / 1 span fabric**

**L = width = from 6' 7" to 22' 11" wide**

**P = projection = from 13' 1" to 32' 9" projection**

Front view

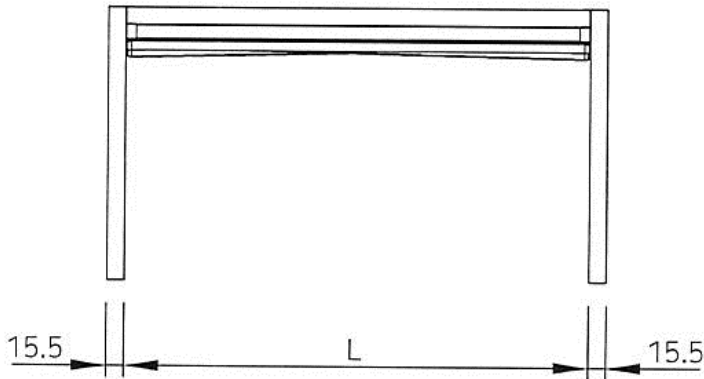

Side view

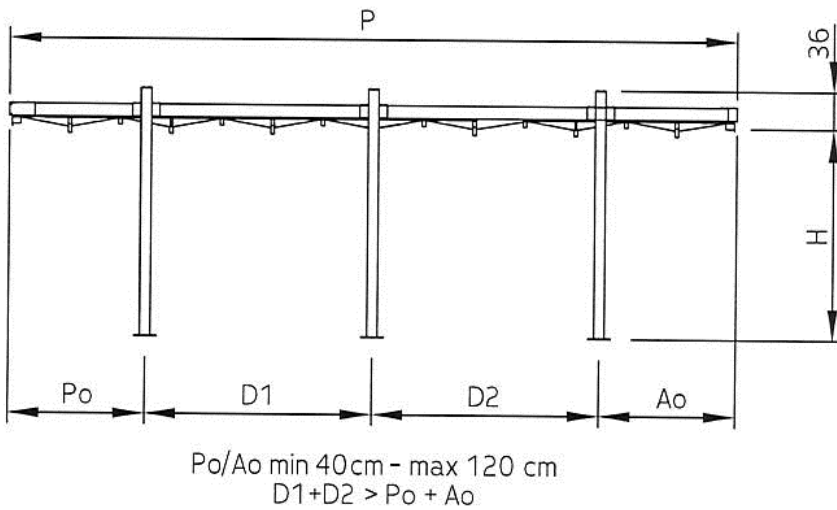

View from above

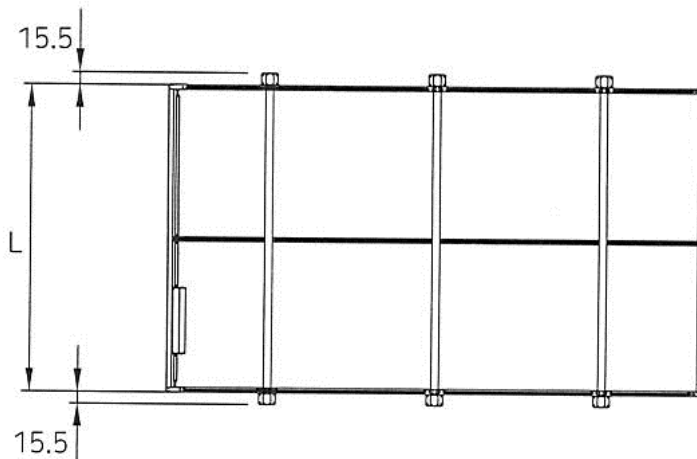

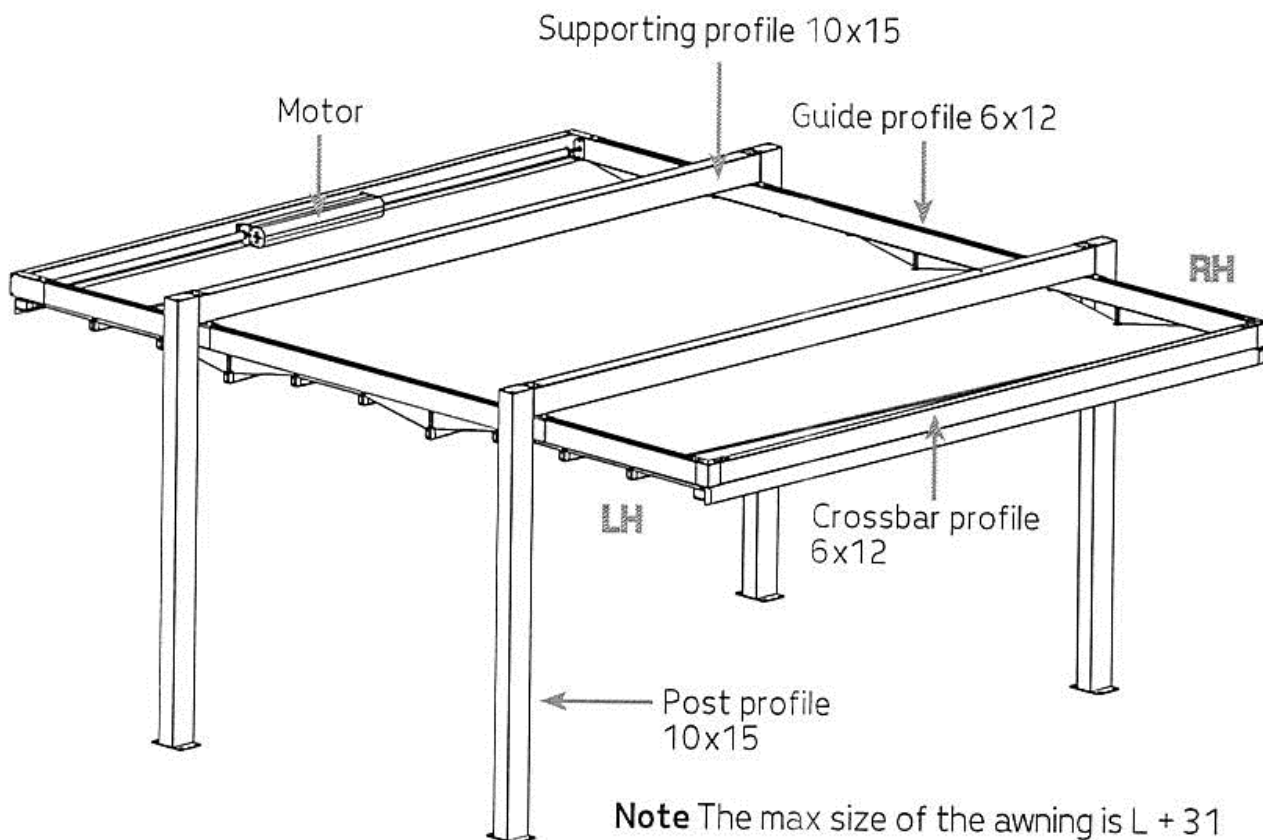

Ground plate  
cod. 2913

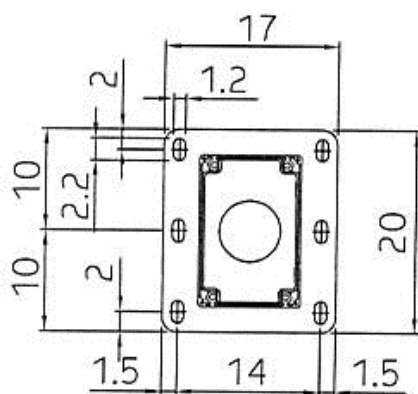

TECNIC 58

Post and supporting bar  
profile cod. 2591

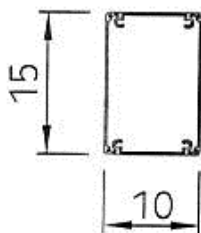

Guide profile  
cod. 2861

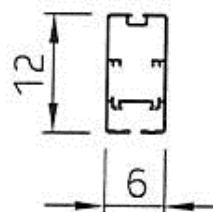

Standard: taut alternating V cover with 2 guides;  
taut V cover discharge from both sides  
with 3 guides

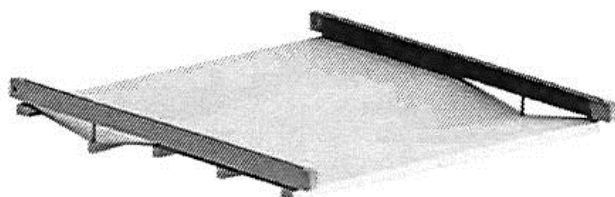

Motor and additional  
crossbar profile  
cod. 2828

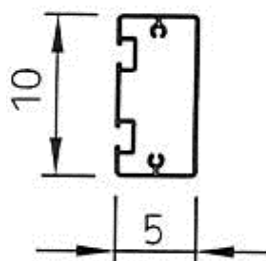

Crossbar profile  
cod. 2799

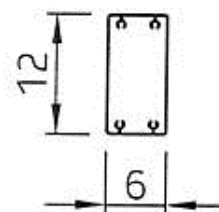

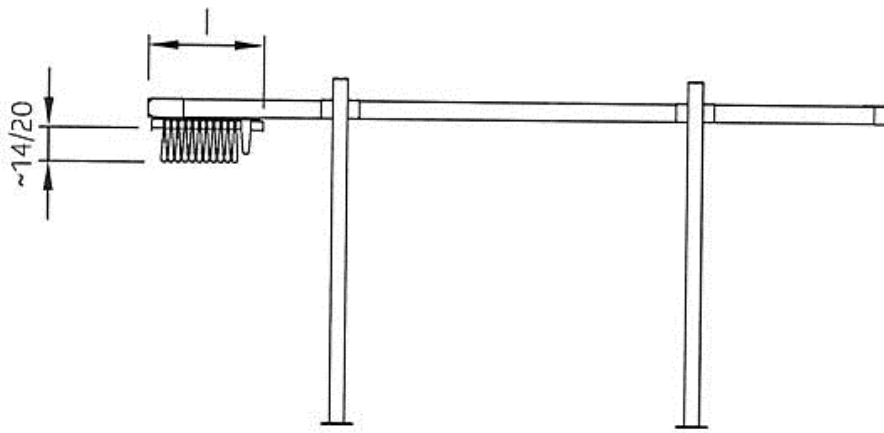

### Dimensions:

**I = Fabric assembly when retracted**

**L = Actual width**

### **Note:**

**Awnings with V cover (Taut Alternating) the number of folds is always even.**

**Maximum post height is 270 cm (8' 8"). Call for price if taller posts are needed.**

**Front view**

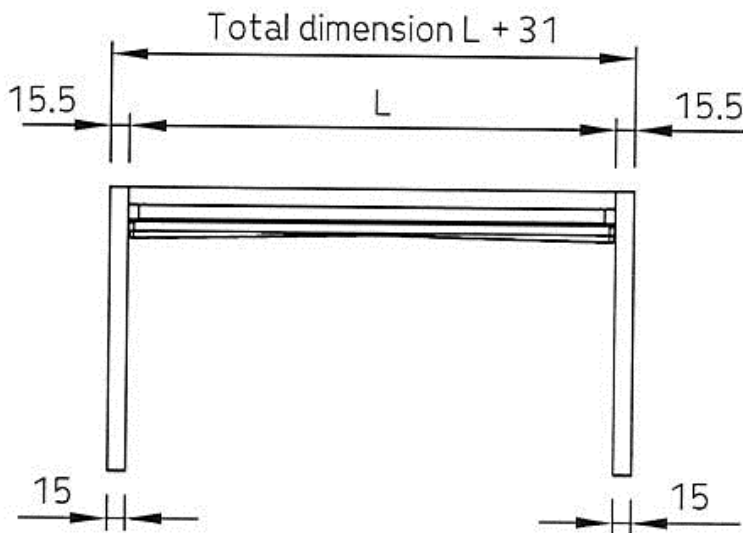

**Rear mounting with arched wall**

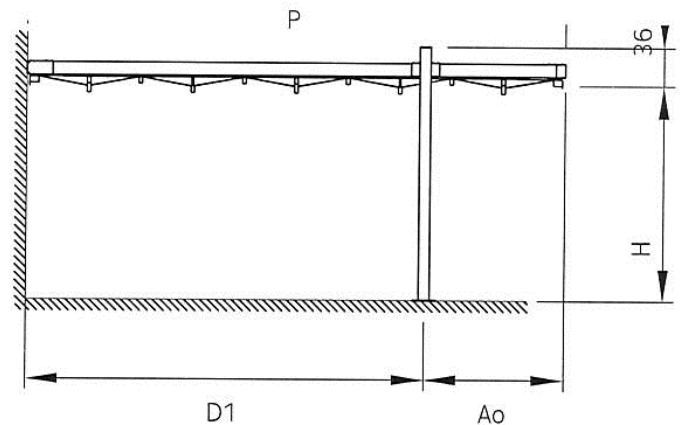

### Optional Mounting on wall



©2017 AWNINGS UNLIMITED INC.  
P.O. Box 1068 7785 Rt. 175,  
Jessup, MD 20794

**JESSUP, MD 800 – 548 – 0408**

### **Note:**

**This product requires training at the Sunair facility in Jessup, MD. Sunair has staff available to help supervise the installation for an additional cost.**

**Further information please call our Jessup office.**