

## PRODUCT FEATURES:



- ☐ Wall Mounted Pergola Type
- ☐ Heavy duty frame ideal for larger spaces, restaurants, dining areas, and large residential patios
- ☐ Protects against sun and rain
- ☐ Keeps deck and patio cool
- ☐ Covers small to larger patio areas
- ☐ Aluminum frame
- ☐ Manually operated up to 268 sq. ft. size as a Type 1.
- ☐ Motorization required on larger sizes
- ☐ Motorized with safety box
- ☐ Optional hood system recommended
- ☐ Integrated gutter for water
- ☐ Drop down screens available

Pergola® MITO is the stronger version in the Tecnic line. Meant for larger spaces, the MITO offers the convenience of a retractable awning, yet the comfort and durability of a stationary awning. Now you can utilize your patio area during fierce mid-day sun and rain. This Pergola® system is great for restaurant and residential patio areas. Larger widths can be covered while the fabric remains in one piece. Larger spaces can be also be covered by coupling multiple systems together with a gutter system. Roll down screens with mesh or clear windows can be added for extra weather protection.

MODEL: MITO	Standard Frame Colors	Standard Widths	Standard Projections	Recommend Application	Fabric	Options
	Anthracite Grey Std. White 9016 Cream 1013 Corten & Sunair std. colors  Custom colors also available	Max 16 ft. with two posts and total 42' 7" wide with 3 sections And 4 posts	Up to 29' 6" projection	Restaurants, Large Residential Patios	Ferrari Precontraint 602  Optional: Ferrari 502 & 302, Soltis 86 & 92	Roll Screens Heaters Lights

### 1. General

The Pergola® Tecnic **MITO** terrace awning is designed for restaurants, cafes, and large residential terraces and spaces. The Mito system is permanent sun-shading frame system with a retractable fabric. The Mito opens and closes by means of a manual gear or tubular motor. Multiple posts can be added together for wider widths with fabric in one piece. Maximum size available with 4 posts is 42' 7" wide x 29' 6' projection

### 2. The fabric

Precontraint 602 is a waterproof fabric PVC fire-resistant Class 2, heat-sealed to provide higher water-proof quality.

### 3. Motor

The Pergola® MITO is operated by a Somfy ALTUS radio 110v tubular motor with a control box. Either an LT50 or LT60 motor is used depending on the size of the unit. Somfy electronic controls are available as an option.

**4. Manual** The manual version is available in "single span" Type 1 versions up to 268 sq. ft. size or 25 sq. meters. The gear is a fast 4.4:1 gear for efficiency.

## Pergola® Model: MITO

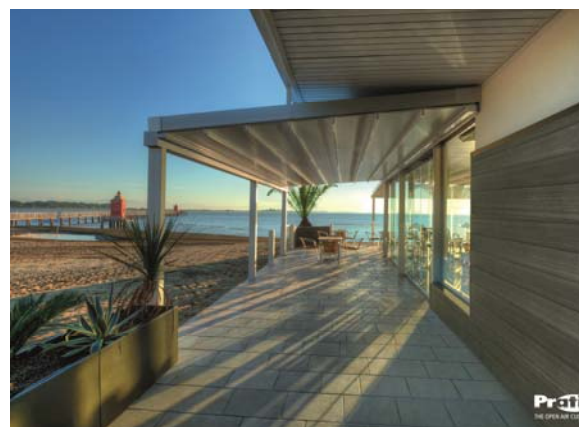

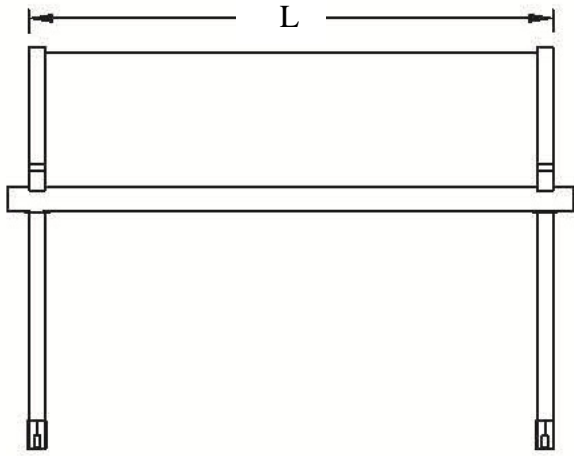

### **TYPE 1: Mito system**

**L max 16' 5" wide**

### **TYPE 2: Mito system**

**2 spans (L from 14' 8" to 29' 6" max total  
L1 & L2 from 6' 6" to 14' 8" wide**

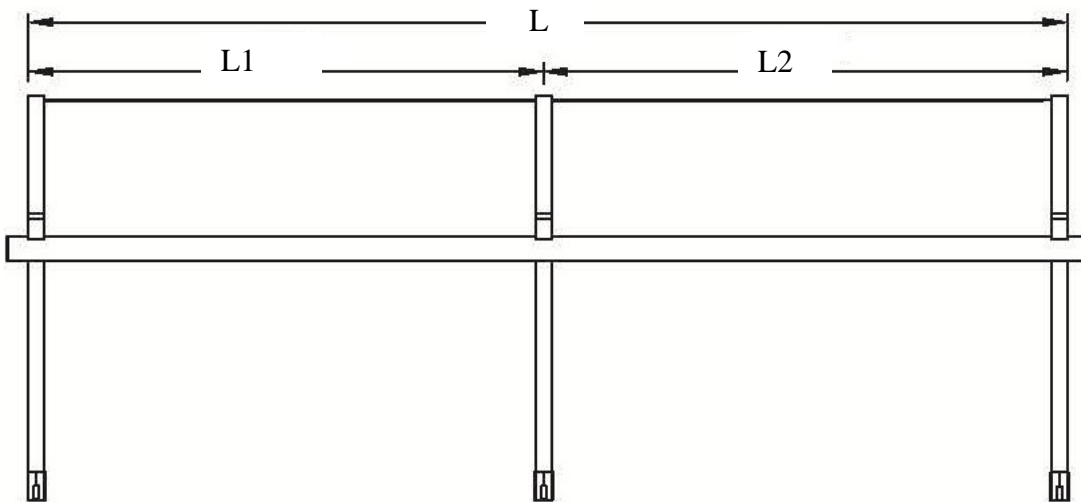

### **TYPE 3: Mito system**

**3 spans (L from 27' 10" to 42' 6")  
L1, L2, & L3 from 6' 6" to 14' 1" wide**

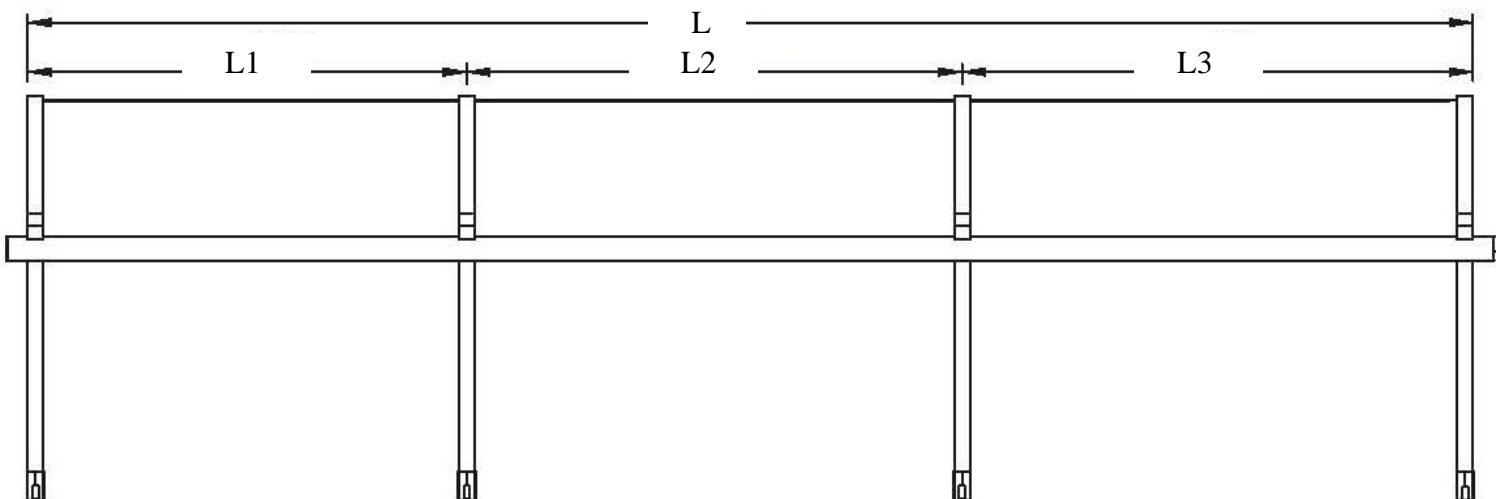



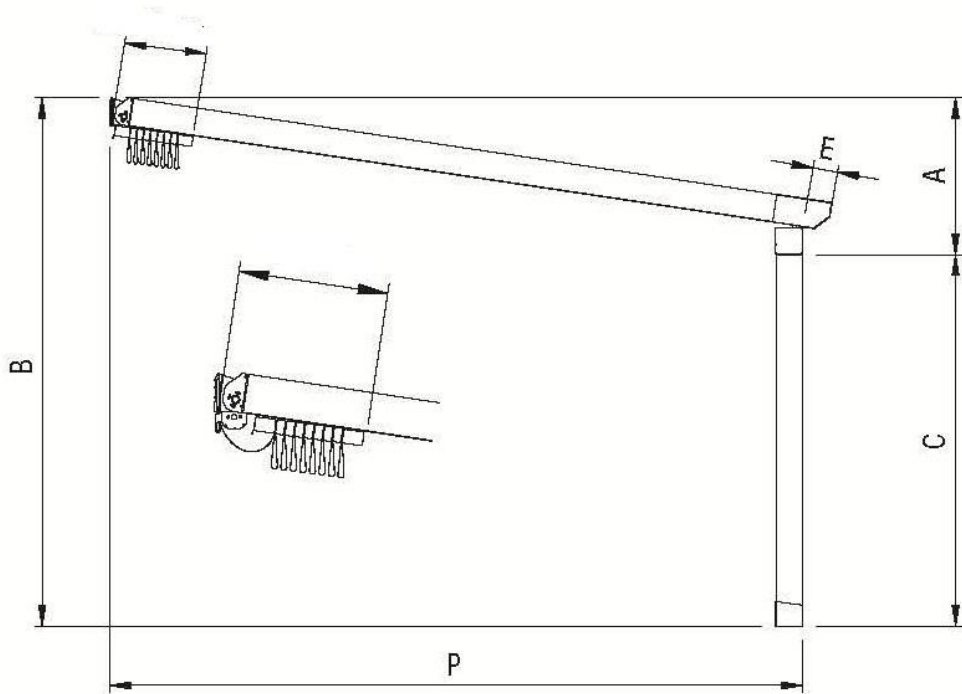

### Dimensions:

**A = Height of Slope**

**B = Height at top back**

**C = Post Height**

**P = Actual Projection from wall**

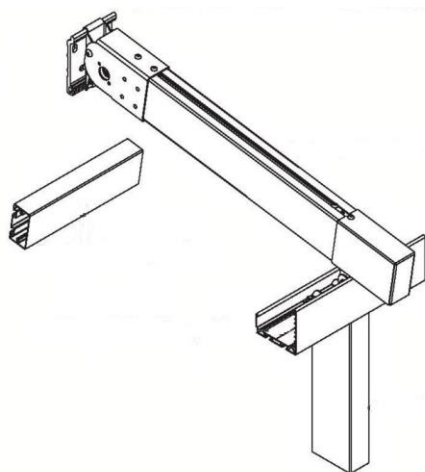
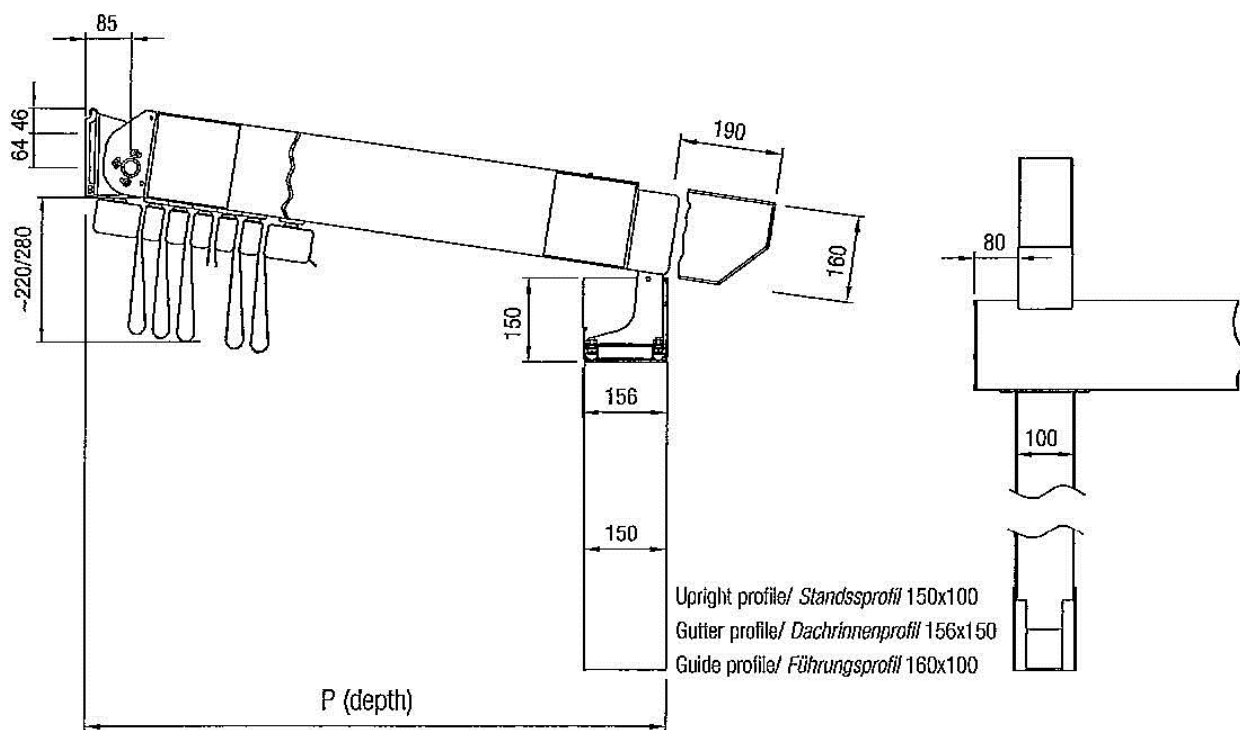

**FOOT PLATE**  
**10 cm x 14.5 cm**

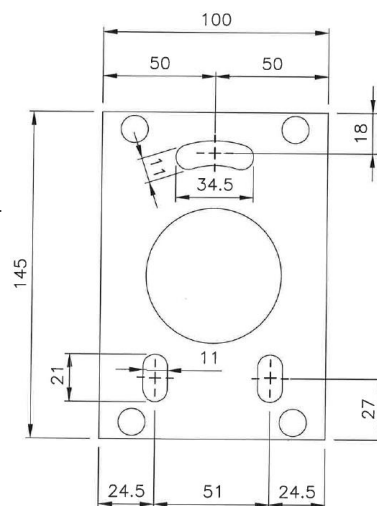

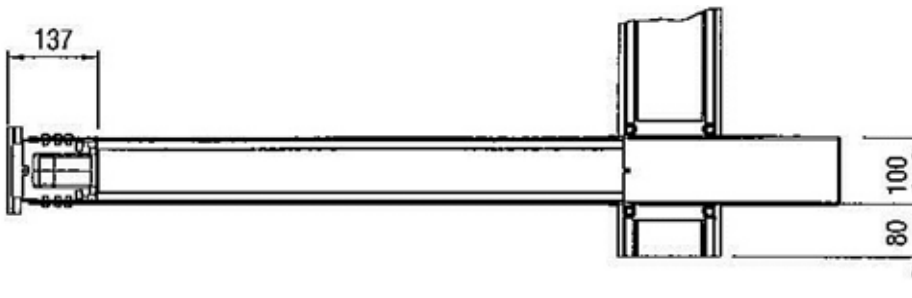

**VIEW FROM ABOVE WITH WALL BRACKET**

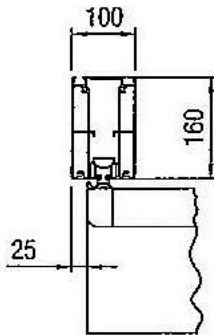

**FRONT SECTION**

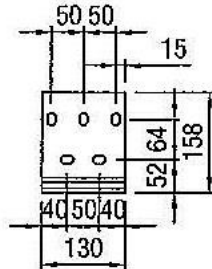

**BRACKET PLATE FOR STANDARD WALL INSTALLATION**

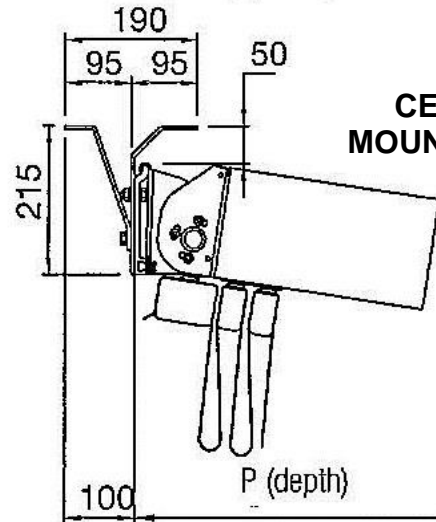

**CEILING MOUNT BRKT.**

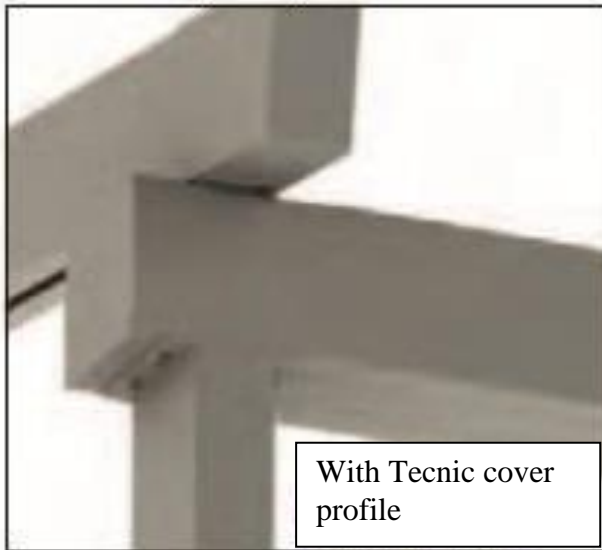

With Tecnic cover profile



Without Tecnic cover profile



©2017 AWNINGS UNLIMITED INC.  
P.O. Box 1068 7785 Rt. 175,  
Jessup, MD 20794

**JESSUP, MD 800 – 548 – 0408**

### Note:

This product requires training at the Sunair facility in Jessup, MD. Sunair has staff available to help supervise the installation for an additional cost.

Further information please call our Jessup office.