



# DecoFlex WireFree™ RTS Switch

Programming/Operating/Assembly Installation Instructions

## 1 DESCRIPTION



**1 CHANNEL**  
White: 1810897  
Ivory: 1810898  
Black: 1810899

**5 CHANNEL**  
White: 1810813  
Ivory: 1810814  
Black: 1810830

The DecoFlex RTS Switch is a wireless radio transmitter compatible with all Somfy RTS Motors and externally mounted RTS receivers.

- Commands are transmitted by radio waves at 433.42 MHz.
- Power: 3V lithium battery, CR 2450 type
- Operating temperature: +5°C/41°F to +40°C/104°F
- Range: Up to 65 Ft.
- Fits into standard Decora Wall Plates

The Somfy DecoFlex WireFree™ RTS switch is a low voltage device which in many cases does not require an electrical box. It can be mounted adjacent to an existing Decora style light switch or as a stand-alone device using the (included) SOMFY low voltage mounting bracket (See installation section for details).

## 2 PROGRAMMING

### A. ADDING A DECOFLEX WIREFREE™ RTS WALL SWITCH - INITIAL INSTALLATION

**NOTE:** During initial programming it is recommended to provide power only to the motor or RTS receiver being programmed.

1. Set the RTS Receiver or Motor into Programming Mode (Refer to the installation instructions of the relevant RTS receiver or motor for this procedure).
2. Select a Channel to be memorized by pressing the appropriate CHANNEL BUTTON. The adjacent LED will light to indicate the channel has been selected. (See figure 1)
3. Using a paperclip or similar device, briefly press the programming button (1 second max) located on the DecoFlex WireFree™ switch (See figure 1). The RTS receiver or motor will confirm the addition of the new DecoFlex switch in their respective manners.

### B. ADDING ADDITIONAL CHANNELS OR DECOFLEX WIREFREE™ WALL SWITCHES

1. Using a paperclip or similar device, press and hold the program button (for 3 seconds) on the **previously addressed DecoFlex switch or channel in memory**. The RTS receiver or motor will confirm programming mode in their respective manners.
2. Select a **NEW** channel or DecoFlex switch to be memorized by pressing the appropriate CHANNEL BUTTON. The adjacent LED will illuminate to indicate the channel has been selected (See figure 1).
3. Using a paperclip or similar device, briefly press the programming button (1 second max) located on the DecoFlex switch (See figure 1). The RTS receiver or motor will confirm the addition of the new channel or DecoFlex switch in their respective manners.

### C. DELETING SPECIFIC CHANNELS OR DECOFLEX WIREFREE™ WALL SWITCH FROM MEMORY

1. Using a paperclip or similar device, press and hold the program button (for 3 seconds) on a **previously addressed DecoFlex switch or channel in memory** (See figure 1). The RTS receiver or motor will confirm programming mode in their respective manners.
2. Select a Channel to be deleted by pressing the appropriate CHANNEL BUTTON. The adjacent LED will illuminate to indicate the channel has been selected (See figure 1).

**NOTE:** Only one channel can be deleted per procedure. To remove/delete additional channels, proceed to **Step 3** then start at **Step 1** for each channel to be deleted.

3. Using a paperclip or similar device, briefly press the programming button (1 second max) located on the DecoFlex switch (See figure 1). The RTS receiver or motor will confirm the deletion of the selected channel or DecoFlex switch in their respective manners.

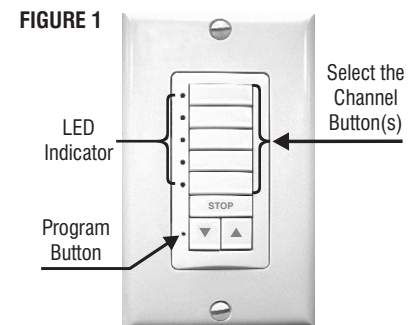

## 3 OPERATING THE DECOFLEX WIREFREE™ WALL SWITCH

1. Select the CHANNEL BUTTON(s) programmed to a specific window covering(s). The adjacent LEDs will illuminate to indicate the channel(s) selected (press CHANNEL BUTTON(s) in successive order to DESELECT, the adjacent LEDs will extinguish to indicate the deselected channels).
2. To raise the window covering(s), press the **UP** button. To lower the window covering(s), press the **DOWN** button.
3. To stop the window covering(s) at any time, simply press the **STOP** button (see figure 2).
4. If a "Preferred Position" has been programmed, the window covering(s) can be commanded to travel to a preprogrammed intermediate position. (Refer to the installation instructions of the relevant RTS receiver or motor for this procedure).

**NOTE:** If a command button (UP, DOWN, STOP) is pressed without a channel button(s) selected, the DecoFlex™ will default to the channel button(s) previously selected. Selecting multiple CHANNEL BUTTONS for "group" activation will result in a sequential-output whereby each channel will activate in sequence from channel 1-5.

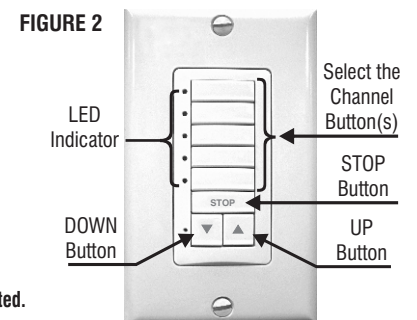

## 4 INSTALLATION

Included is a special SOMFY low voltage device mounting bracket which attaches to drywall and eliminates the need for an electrical box.

The bracket can be used in **two** mounting type configurations, they are as follows:

1. The bracket is specifically designed for mounting the DecoFlex WireFree™ RTS wall switch to an adjacent (pre-existing) Decora style light switch (see below). This unique mounting bracket allows the necessary spacing for 2 adjacent switches and a new "Double Gang" (2 Gang) wall plate to be installed (See photo 8) resulting in an aesthetically pleasing professional installation.

**NOTE:** When following configuration 1. The mounting bracket is not designed to be used in conjunction with "old-work" or retrofit electrical boxes. (Please check local codes to determine if an electrical box is required for your installation.)

For increased radio performance, Somfy recommends the use of non-metallic electrical enclosures.

2. The bracket can also be used for individual or "stand-alone" (1 switch) mounting configurations.

### Tools required for installation:

Screw drivers (Phillips and Bladed), Dry-wall saw, Wall stud sensor, Non-marring tape and pencil

1. Locate an existing light switch and remove wall plate exposing electrical box. Somfy recommends shutting off power to the exposed electrical box prior to installation.

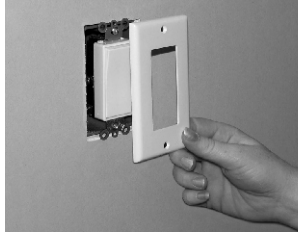

2. Using a stud sensor, locate the stud nearest to exposed electrical box. Then mark (for reference) with removable tape or pencil.

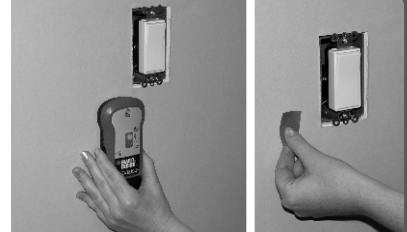

3. Place the flat side of mounting bracket (included) against the wall and align the **thin side** over the outside edge of the existing electrical box (**opposite the stud side**). Center the bracket to align the mounting screw height with existing switch, then trace the inside shape of the bracket on wall using a pencil or thin marker.

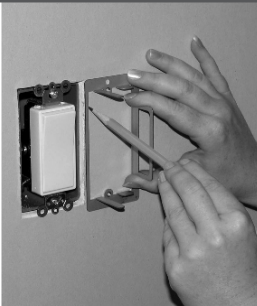
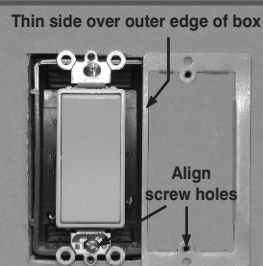

4. Using a dry-wall saw (or similar) begin to cut the dry-wall along the traced outline. **Do not cut hole larger than outline as this may result in a loose fitting bracket.** \*For greater accuracy please refer to the recommended hole dimensions on reverse page.

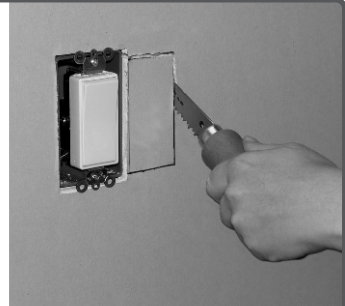

## 4 INSTALLATION CONT'D

5. Insert bracket (as shown) into hole, keeping the thin side closest to the edge of the existing switch box.

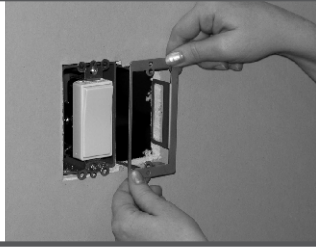

6. Carefully bend bracket tabs 90 degrees behind the dry-wall to ensure a tight secure fit.

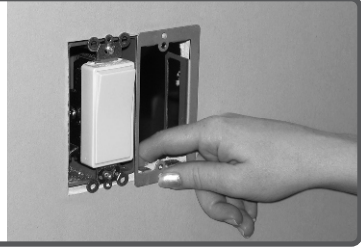

7. Position the DecoFlex RTS switch into mounting bracket aligning the screw holes. Secure switch to mounting bracket with screws (provided).

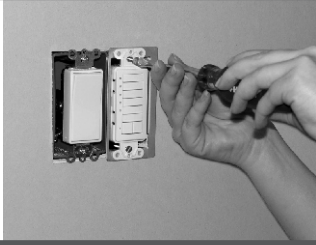

8. Attach a new (2 gang) or double gang Decora style wall plate over both switches to complete installation.

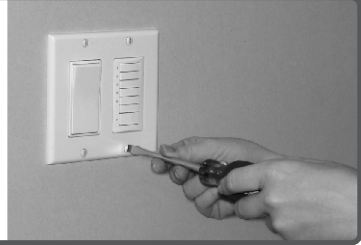

\* Hole dimensions for (Step 4) mounting bracket (1 5/8" W x 3 7/16" L)

## 5 REPLACING THE BATTERY

The DecoFlex WireFree™ RTS switch is designed to provide years of maintenance free performance. Should the battery become discharged, the LED indicator lights will no longer function when the channel button is selected or an Up/Stop/Down command is activated. As a result, the radio signal will be reduced or not communicated to the RTS receiver or motor.

The battery can be easily replaced by exposing the SWITCH BASE ASSEMBLY board of the DecoFlex WireFree™ switch. Simply slide the battery out of its holder and replace with a new **3V Lithium battery (type 2450)** maintaining the correct polarity.

**NOTE: Batteries should be disposed of properly according to local regulations.**

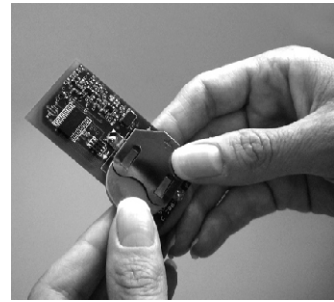

## 6 ASSEMBLE 2, 3, & 4 CHANNEL SWITCHES

1. Begin with a standard (assembled) 1 or 5 channel button DecoFlex switch - Using a small flat blade screw driver, carefully separate the SWITCH BASE ASSEMBLY from the FACEPLATE (as shown in figure 1).
2. Add or remove CHANNEL BUTTONS (as required) from the SWITCH BASE ASSEMBLY (as shown in figure 2). Be certain the SWITCH BASE ASSEMBLY remains intact.
3. Attach new 2, 3, or 4 channel button face plate (as shown in figure 3 & 4).

5 Channel DecoFlex Wall Switch (Exploded view)

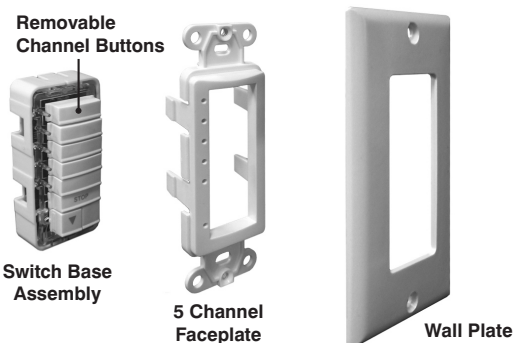

Figure 1.



Figure 2.



Figure 3.

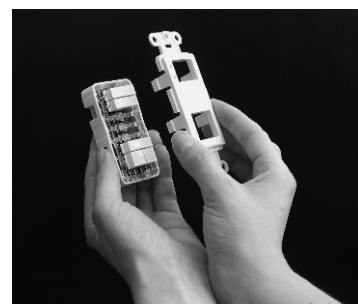
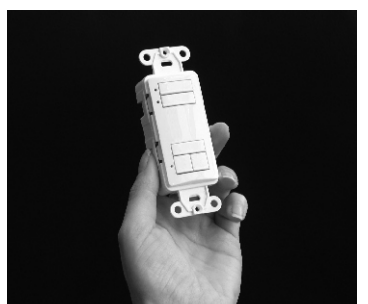

Figure 4.



## 7 REPLACE STANDARD (BLANK) CHANNEL BUTTONS WITH PRINTED CHANNEL BUTTONS

1. Using a small flat blade screw driver, carefully separate the SWITCH BASE ASSEMBLY from the FACEPLATE (as shown in figure 1).
2. Replace standard (blank) or temporary labeled CHANNEL BUTTON(s) with new printed CHANNEL BUTTON(s).
3. Attach new CHANNEL BUTTON FACE PLATE (as shown in figure 3 & 4).



2 Channel Switch Assembly



3 Channel Switch Assembly



4 Channel Switch Assembly

### FCC INFORMATION

This device complies with Part 15 of the FCC Rules. Operation is subject to the following two conditions:

1. This device may not cause harmful interference, and
2. This device must accept any interference received, including that which may cause undesired operation.

**NOTE:** This equipment has been tested and found to comply with the limits for CLASS B digital device, pursuant to Part 15 of FCC Rules. These limits are designed to provide reasonable protection against harmful interference when the equipment is operated in a commercial environment. This equipment generates, uses and can radiate radio frequency energy and, if not installed and used in accordance with the instructions, may cause harmful interference to radio communications. However, there is no guarantee that interference will not occur in a particular installation. If this equipment does cause harmful interference to radio or television reception, which can be determined by turning the equipment off and on, the user is encouraged to try to correct the interference by one or more of the following measures:

1. Reorient or relocate the receiving antenna
2. Increase the separation between the equipment and receiver
3. Connect the equipment into an outlet on a circuit different from that to which receiver is connected
4. Consult the dealer or experienced radio/TV technician for help.

**WARNING: Changes or modifications not expressly approved by the manufacturer could void the user's authority to operate the equipment.**

**SOMFY SYSTEMS, INC.**  
North America Headquarters  
47 Commerce Drive  
Cranbury, NJ 08512  
Phone: US: 1-800-22-SOMFY  
NJ: (609) 395-1300  
Fax: (609) 395-1776

**FLORIDA**  
6100 Broken Sound Pkwy. N.W.,  
Suite 14  
Boca Raton, FL 33487  
Phone: (877) 227-6639  
Fax: (561) 995-7502

**CALIFORNIA**  
15291 Barranca Parkway  
Irvine, CA 92618-2201  
Phone: (877) 727-6639  
Fax: (949) 727-3775

**SOMFY ULC**  
SOMFY Canada Division  
6315 Shawson Drive, Unit #1  
Mississauga, Ontario L5T1J2  
Phone: CN: 1-800-66-SOMFY  
CN: (905) 564-6446  
Fax: (905) 564-6448

SOMFY SYSTEMS, INC. reserves the right to change, update or improve this document without prior notice.